



Ph: 02 8834 2400 • Email: iwws@iwws.net • Website: www.iwws.net

JANUARY 2021
EDITION

AZPK SERIES PURGE BAFFLE KITS



Purge Baffles for High-Purity Tube & Pipe Welding

Durable tube and pipe baffle systems are designed for quick, cost effective purging of popular pipe and tube diameters and schedules. They're engineered to reduce time spent purging a run of pipe, and greatly decrease labor costs, and save you money on expensive argon shield gas. Most importantly, purge baffles are proven to improve tube and pipe weld quality.

Based on your application, choose between our heavy-duty, dedicated Purge Baffles designed for a single pipe diameter, or choose a versatile Modular Baffle System which includes a variety of interchangeable parts that can be customized to handle all of the pipe diameters and schedules that come your way.

Part No.	Size	Part No.	Size	Part No.	Size
AZPK100112	100-112 mm	AZPK255280	255-280 mm	AZPK4753	47-53 mm
AZPK105120	105-120 mm	AZPK275300	275-300 mm	AZPK5258	52-58 mm
AZPK120140	120-140 mm	AZPK290320	290-320 mm	AZPK5463	54-63 mm
AZPK135155	135-155 mm	AZPK310340	310-340 mm	AZPK5868	58-68 mm
AZPK145165	145-165 mm	AZPK325355	325-355 mm	AZPK6472	64-72 mm
AZPK160180	160-180 mm	AZPK345375	345-375 mm	AZPK6876	68-76 mm
AZPK175200	175-200 mm	AZPK360390	360-390 mm	AZPK7281	72 - 81 mm
AZPK195220	195-220 mm	AZPK380410	380-410 mm	AZPK7586	75-86 mm
AZPK215240	215-240 mm	AZPK3843	38-43 mm	AZPK8091	80-91 mm
AZPK235260	235-260 mm	AZPK4348	43-48 mm	AZPK8695	86-95 mm
				AZPK90101	90-101 mm

PURGE BAFFLE ASSEMBLY



Step 1: Assemble the inlet to what will be your forward baffle. Insert the threaded portion of the gas inlet through the centre hole of the baffle and secure with the nut.



Step 2: Assemble the outlet to what will be your trailing baffle. Like with the forward baffle, insert the threaded portion of the gas outlet through the centre hole of the baffle and secure with the nut.



Step 3: With both baffles assembled, affix the first of the connecting arms to the forward baffle.

Note: Deciding whether to use the flexible arms or the rigid arms in your application depends on the types of bends in the pipe run.

a) Straight pipe: Use both rigid arms.

b) Moderate - std elbows: Use 1 rigid arm as the forward connector and 1 flexible arm as the trailing connector.

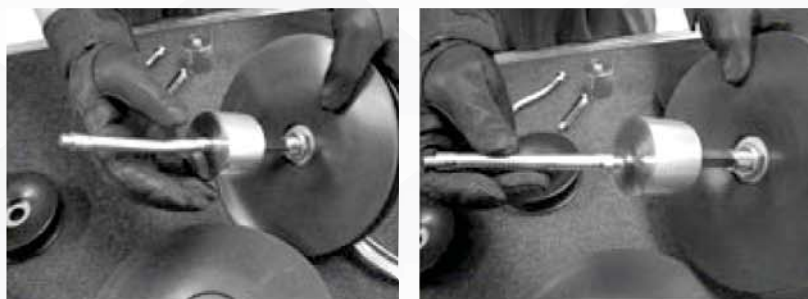

Step 4: Then, thread the diffuser onto each of the connecting arms.



Step 5: Connect the trailing baffle to the trailing connecting arm.

Kit includes:

1. Gas inlet with nut & safety hook
2. Gas outlet with nut & sintered excess pressure vent
3. 9 m pull cable & 9 m gas hose with quick disconnect
4. Ridge arms 2 x medium, 1 x short
5. Flexible arm x 1
6. Gas diffuser x 1
7. Silicon baffles x 2

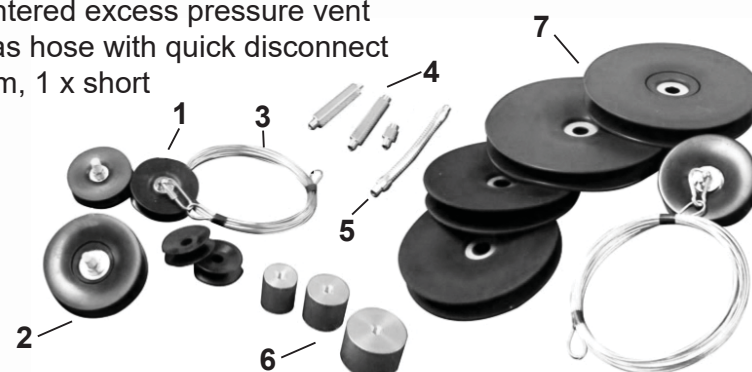

*** holesaw not included***

TUBE & PIPE NOTCHER

Notching a round, or square tube or pipe has never been easier. Do quick and consistent notches on straight, angled and curved tubes with complex angles. The new BuildPro® Tube & Pipe Notcher makes alignment and length control of the notch easy!

- Heavy duty, all steel construction
- Cuts notches in 1" - 2-1/2" O.D tubing.
- Adjust cutting angle up to 90°



PRFA

1260 & 2640 SELF SHIELDED FLUX CORE GUNS

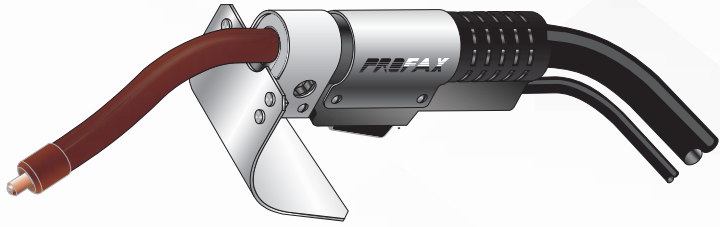

- Economical replacement components including liner.
- 350 amps / 60% duty cycle
- Wide variety of wire sizes
- Easy field repair
- Adaptor kits available for most models of feeders

1260 Gun

1260-10 - 3 m (10') suits Lincoln LN7, LN8, LN9, LN25 and LN25 PRO
1260-15 - 4.5 m (15') suits Lincoln LN7, LN8, LN9, LN25 and LN25 PRO
1260-10MLR - 3 m (10') suits Miller voltage sensing wire feeders
1260-15MLR - 4.5 m (15') suits Miller voltage sensing wire feeders
1260-10LP - 3 m (10') suits Lincoln LN25 pro
1260-15LP - 4.5 m (15') suits Lincoln LN25 pro
TX1260-10 - 3 m (10') suits Euro style wire feeders
TX1260-15 - 4.5 m (15') suits Euro style wire feeders

2640 Gun

2640-8 - 2.4 m (8') Use w/ LN22, E23
2640-10 - 3 m (10') Use w/ LN22, E23
2640-15 - 4.5 m (15') Use w/ LN22, E23

GOOSENECKS FOR K126-11 & K126-12

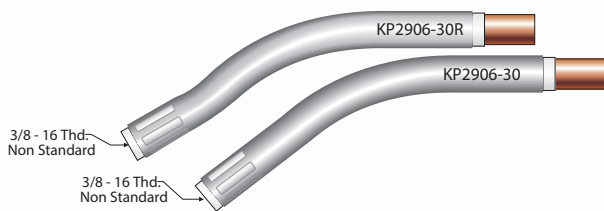

PXKP2906-30R - 30° Gooseneck jacketed 152 mm (6") with reverse bend
PXKP2906-30 - 30° Gooseneck jacketed 152 mm (6") without reverse bend



PXKP2906-30R-L - 30° Gooseneck jacketed 304 mm (12") with reverse bend
PXKP2927-30R-L - 30° Gooseneck braided 304 mm (12") with reverse bend

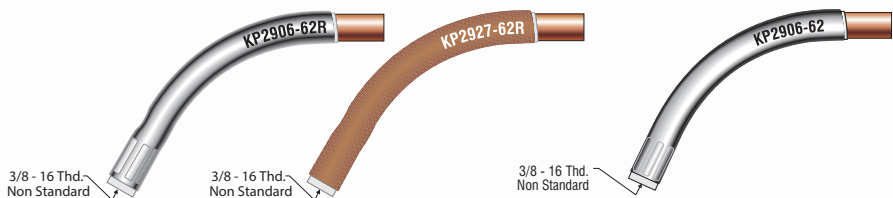

PXKP2906-62R - 62° Gooseneck jacketed 152 mm (6") with reverse bend
PXKP2927-62R - 62° Gooseneck braided 152 mm (6") with reverse bend
PXKP2906-62 - 62° Gooseneck jacketed S/B 152 mm (6") without reverse bend

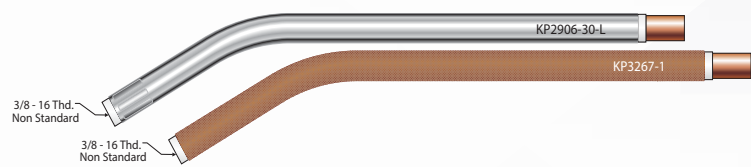

PXKP2906-30-L - Gooseneck 30° jacketed 304 mm (12") without reverse bend
PXKP3267-1 - Gooseneck 30° braided 304 mm (12") without reverse bend

GOOSENECKS CONSUMABLES

Contact Tip Holder

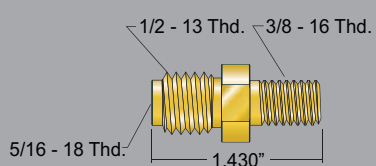

PXKP2908-1 - Tip holder

Thread Protector

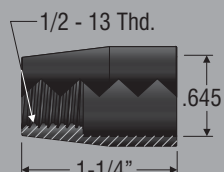

PXKP2907-1 - Thread protector

Contact Tips

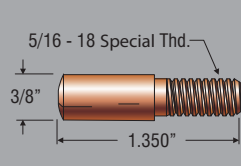

PXKP2745-035 - 0.9 mm (.035")
PXKP2745-040 - 1.0 mm (.040")
PXKP2745-045 - 1.2 mm (.045")
PXKP2745-052 - 1.3 mm (.052")
PXKP2745-116 - 1.6 mm (1/16")
PXKP2745-072 - 1.8 mm (.068"-.072")
PXKP2745-564 - 2.0 mm (5/64")
PXKP2745-332 - 2.4 mm (3/32")
PXKP2745-764 - 2.8 mm (7/64")
PXKP2745-18 - 3.0 mm (1/8")



PRFA

600 AMP WATER COOLED MIG GUN

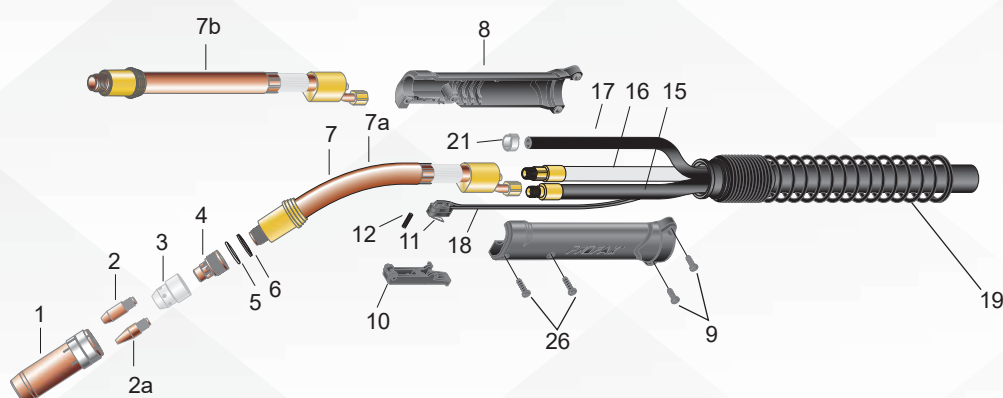

1. PX26W50F - Nozzle 12.5 mm (1/2") flush
PX26W62F - Nozzle 16 mm (5/8") flush
PX26W75F - Nozzle 19 mm (3/4") flush
PX26W37R - Nozzle 10 mm (3/8") recessed
PX26W50R - Nozzle 12.5 mm (1/2") recessed
PX26W62R - Nozzle 16 mm (5/8") recessed
PX26W75R - Nozzle 19 mm (3/4") recessed
- 1a. PX26W50RWC - Water cooled nozzle 12.5 mm (1/2") rec
PX26W62RWC - Water cooled nozzle 16 mm (5/8") rec
PX26W75RWC - Water cooled nozzle 19 mm (3/4") rec
2. PX16W35 - Contact tip 0.9 mm (.035")
PX16W40 - Contact tip 1.0 mm (.040")
PX16W45 - Contact tip 1.2 mm (.045")
PX16W364A - Contact tip 1.2 mm (3/64") aluminium
PX16W52 - Contact tip 1.3 mm (.052")
PX16W116 - Contact tip 1.6 mm (1/16")
PX16W116A - Contact tip 1.6 mm (1/16") aluminium
PX16W564 - Contact tip 2.0 mm (5/64")
PX16W332 - Contact tip 2.4 mm (3/32")
- 2a. PX16WT35 - Contact tip tapered 0.9 mm (.035")
PX16WT45 - Contact tip tapered 1.2 mm (.045")
PX16WT52 - Contact tip tapered 1.3 mm (.052")
PX16WT116 - Contact tip tapered 1.6 mm (1/16")
3. PX26HTI - Insulator hi-temp
4. PX56W - Gas diffuser
5. PX228 - O'ring hi-temp
6. PX229 - Washer insulating
7. PX66W50 - Gooseneck assembly 50°* 203 mm (8") o.a.l. from handle
7a. PX66W50S - Optional gooseneck assembly 50° (50 mm shorter) 152 mm (6") o.a.l. from handle
7b. PX66W180 - Optional gooseneck straight 203 mm (8") o.a.l. from handle
8. PX86W - Handle w/ screws
9. PX126SS - Short screw for handle (2 required)
10. PX96T - Trigger
11. PX96S - Switch
12. PX196 - Spring trigger
15. PX602-12 - 3.5 m (12') Red power cable assembly
PX602-15 - 4.5 m (15') Red power cable assembly
PX602-15E - 4.5 m (15') Red power cable assembly Euro
16. PX603-12 - 3.5 m (12') Conduit assembly
PX603-15 - 4.5 m (15') Conduit assembly
17. PX604-12 - 3.5 m (12') Water in hose assy w/ fittings
PX604-15 - 4.5 m (15') Water in hose assy w/ fittings
18. PX605-12 - 3.5 m (12') Switch assy w/ switch & terminals
PX605-15 - 4.5 m (15') Switch assy w/ switch & terminals
19. R186-S - Spring strain relief
21. PX168 - Hose clamp (2 required)
26. PXR185-SC - Screw for housing and handle (6 required)

* All guns shipped with matching quick connects for water

Tweco Connection • Miller Connection • Lincoln Connection
Euro Connection available



Machine torch version
available

Amps	Duty Cycle	Type/Gas Mix
600	100%	CO2 75-25 Flux Core
500	100%	Pulse Mig 80-20 98-2 95-5

INEXPENSIVE, RUGGED AND POWERFUL
THE AP-1 MOUNTS EASILY ONTO MOST
AUTOMATIC SUBMERGED ARC WELDING
EQUIPMENT

AIR POWERED
FLUX RECOVERY SYSTEM



Comes complete with 1.52 m
hose, hopper mounting
brackets, sight window for
hopper, dust bag and NZ-1
flux pick-up nozzle

Standard Features

- Adds no oil or water to the flux since flux is never in compressed air stream.
- Vacuum air pump is on exhaust side and undesirable contaminants, fines and dust are discharged into a very efficient dust bag assembly.
- No moving parts in air pump, and no internal filters to wear out.
- Direct recycling of flux back to hopper.
- Sight window in AP-1 and hopper for easy flux level indication.
- Very efficient air pump produces a higher vacuum, uses less air and is quieter than most competitive models.
- Versatile, with quick attach options.

Part No.	Input Power	Weight	Dimensions H x W x D cm	Flux Capacity
AP-1 PLUS	Compressed air @ 70-100 psi	10.4 kg	52.7 x 47.5 x 24.8 cm	Determined by flux hopper i.e. Lincoln and Miller standard Hopper - 8.2 kgs

No electrical input required



WELDING POSITIONER SPECIFICATION

Specifications	WP250-2	WP500-2	WP1000-2	WP2000-4	WP6000-4
Capacity Vertical:	113 kg	226 kg	453 kg	907 kg	2721 kg
Capacity Horizontal:	199 kg	408 kg	793 kg	1587 kg	4309 kg
Load Center of Gravity:	101 mm	152 mm	152 mm	304 mm	304 mm
Tilt:	Manual	Power	Power	Power	Power
Tilt Angle (Degrees):	0 - 90	0 - 135	0 - 135	0 - 135	0 - 135
Tilt Angle Indicator:	N/A	N/A	N/A	Standard	Standard
Ground Capacity:	150 amps	300 amps	500 amps	800 amps	800 amps
Grounding Device:	Carbon	Brass	Brass	Rotary	Rotary
High Freq. Protection:	Yes	Yes	Yes	Yes	Yes
Volt/Ac:	115 or 230	115 or 230	115 or 230	220 or 440 (3 PH.)	220 or 440 (3 PH.)
Power Req. 115V:	5 amp	10 amp	10 amp	10 amp	10 amp
Table Thickness:	14 mm	22 mm	25 mm	25 mm	25 mm
Table Diameter:	349 mm	198 mm	622 mm	901 mm	1200 mm
Table Configuration:	3 - Slot	3 & 4 - Slot	3 & 4 - Slot	3 & 4 - Slot	3 & 4 - Slot
Optional Chucks:	WPC-6 & 11	WPC-12 & 16	WPC-12, 16 & 20	WPC-16, 20 & 25	WPC-20 & 25
Optional Grippers:	-	WPG-22	WPG-22 & 26	WPG-22, 26 & 34	WPG-22, 26 & 34
Table Height (Horizontal):	335 mm	641 mm	855 mm	911 mm	1092 mm
Table Center Height (Vertical):	255 mm	539 mm	736 mm	781 mm	927 mm
Through Hole:	28 mm	N/A	N/A	N/A	N/A
Table R.P.M:	0 - 5.5	0.4 - 4	0.2 - 2	0.1 - 1.2	0.1 - 1.2
Rotation Motor H.P:	1/8 H.P.	1/6 H.P.	1/4 H.P.	1 H.P.	2 H.P.
Variable Speed Rotation:	Yes	Yes	Yes	Yes	Yes
Foot Control:	Single	Fwd./Rev.	Fwd./Rev.	Opt.	Opt.
Hand Pendant:	Optional	Optional	Optional	Standard	Standard
Anchor Points:	4	4	6	6	6
Levelling Bolts:	N/A	Included	Included	Included	Included
Unit Width:	317 mm	660 mm	819 mm	914 mm	1200 mm
Unit Length:	533 mm	860 mm	1231 mm	1562 mm	1828 mm
Shipping Weight (Approx.):	52 kgs	264 kgs	546 kgs	746 kgs	1239 kgs



WP250-2



WP500-2



WP1000-2



WP2000-2



WP6000-2



WELDING POSITIONER CHUCKS



Features

- 3 Jaw Self Centering
- Reversible Jaws
- Easy Mounting

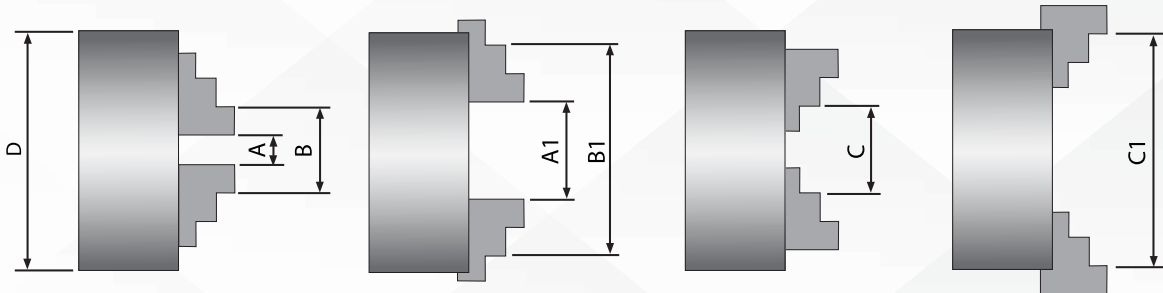

Part No.	Diameter	Clamping Range A - A1	I.D. Range B - B1	External Jaw Clamping Range C - C1	Weight	Used on Positioners
PXWPC-6	158 mm	3.2 - 54 mm	50 - 158 mm	57 - 142 mm	9 kg	WP250-2
PXWPC-12	317 mm	12.5 - 139 mm	95 - 314 mm	98 - 314 mm	47 kg	WP500-2, WP1000-2
PXWPC-16	400 mm	16 - 209 mm	120 - 400 mm	120 - 400 mm	75 kg	WP500-2, WP1000-2, WP2000-4
PXWPC-20	498 mm	25 - 279 mm	149 - 498 mm	149 - 498 mm	117 kg	WP1000-2, WP2000-4, WP6000-4
PXWPC-25	628 mm	50 - 349 mm	168 - 628 mm	168 - 628 mm	209 kg	WP2000-4, WP6000-4

WELDING POSITIONER GRIPPERS

Features

- Self Centering
- Reversible Jaws
- Easy Mounting



Part No.	Positioner	O.D. Capacity	I.D. Capacity
WPG-22	WP500-2, WP1000-2, WP2000-4, WP6000-4	25 - 381 mm	101 - 558 mm
WPG-26	WP1000-2, WP-2000-4, WP6000-4	38 - 457 mm	152 - 660 mm
WPG-34	WP2000-4, WP-6000-4	50 - 660 mm	152 - 863 mm



WELDING CYLINDER CARTS

Popular cylinder truck can be used for gas cylinders up to 12" (30 cm) in diameter or for hauling boxes on the 7 x 14" (17.8 x 35.6 cm) base plate. Load capacity rated at 500 lb (225 Kg).

782385 - Cylinder Cart



Sumner #213 carts are ideal for handling two cylinders, with diameters >13" (33 cm). High rail design contains cylinders while moving about job sites. Carts come with 13 x 25" (33 x 63 cm) base plate and a large open tool tray. Sumner #209 Carts are 9 1/4" x 9 x 18" (22.9 x 45.7 cm).



Part No	Description	Wheel	Overall Dimensions Size (H x D x W)	Weight
782482	Cylinder cart with safety chain	40 cm Pneumatic	113 x 56 x 92 cm	26.8 kg
782443	Cylinder cart with lifting eye, divider wall & double containment bars	40 cm Pneumatic	167 x 46 x 82 cm	34.2 kg
782495	Cylinder cart with lifting eye, divider wall & double containment bars	40 cm Pneumatic	168 x 56 x 93 cm	49.4 kg



3 WHEEL CYLINDER CART

- 3 wheel trolley offer stability & safety for the worker.
- Holds 2 cylinders
- Lockable container for tools
- Lockable castor
- 355 mm (14") solid rubber wheels

SUMNER



WELDING CYLINDER CARTS

Sumner #207 Small - Medium cylinder cart.
High rail design contains cylinders while moving about job sites.
Carts come with 7.5" x 15.5" (190 x 394 MM) base plate.

782359 - Cylinder Cart

LIFTABLE CYLINDER CARTS

- Certified to AS4991 - 2004.
- Certified 315 kg safe working load.
- Designed to hold various diameter sized fuel gas cylinders up to 15" (38 cm) and "G Size" oxygen cylinders.
- Four individual 2" (5 cm) ratchet straps to locate and secure the cylinders into position.
- Each strap breaking strain is 1587 kg with a safe working load limit of 907 kg.
- Lifting eye - crane capability.
- Forklift tyne - capability.
- 16" (40 cm) pneumatic tyres.
- 176 cm H x 98.5 cm W x 66 cm D
- Weight 60 kgs

782250 - Industrial Gases Cylinder Trolley



- Load capacity of 200 kgs (440 lbs)
- Weight 26.4 kgs
- H x W x Base 99.5 cm x 82.5 cm x 33 x 63.5 cm
- Flat packed

AFTILTT - Cylinder Cart 3 Wheel Tilt

ARCFORCE
BETTER QUALITY THE POWER TO WELD BETTER WELD



Stable Cut

STRAIGHT, HIGH QUALITY TORCH CUTS.... EVERYTIME



- Consistent push or pull cutting with pre set mechanized speed controller
- Strong magnets allow cutting from horizontal to vertical positions
- One hand operation, with cutting capabilities up to 48" lengths
- Set bevel cuts from 0-60 degree's
- Adjustable knobs allowing set up in seconds
- Field usable without the use of electricity.

Part No.

SC15 - Stable Cut 15" (375 mm) cut cap

SC24GT - Guide track 26" Stable cut 24"

SC36GT - Guide track 38" Stable cut 36"

SC48GT - Guide track 50" Stable cut 48"



Straight high quality torch cuts



Clean bevel cuts up to 60°



EASY FEEDER



The EASYkleen EASY Feeder is an optional accessory for the EASYkleen range of weld cleaners. It offers the user the ability to have a solution fed brush option when required for certain jobs, whilst being easily detachable to revert back to the dipping process that the EASYkleen machines usually employ.

The feeder unit itself is designed in a stainless steel case, with the same pump technology as the mepBLITz DC-i5 to deliver the weld cleaning solution to the brush electrode.

The EASYkleen EASY Feeder only needs to be attached to the outputs of your weld cleaner and it is ready for use.

A trigger on the handle brings through solution as required to the solution fed brush electrode to perform the weld cleaning. There is both a regular solution fed brush and TIP brush style solution fed brush for each size feeder unit.

M6 Style (for Plus unit)

EKEFM6W - Easykleen Feeder M6 Style

EKEFM6BPHSW - M6 Solution Fed Brush 3 Pack

EKEFM6BPSW - M6 Solution Fed Brush 5 Pack



M8 Style (for Pro unit)

EKEFM8W - Easykleen Feeder M8 Style

EKEFM8TIP - M8 Solution Fed Brush 3 Pack

EKEFM8STD - M8 Solution Fed Brush 5 Pack



WELDING TENT



912019 - 3 m x 2 m Welding Tent

Designed for outdoor work, providing full protection of the welding process to the elements and allow for welding in all weather conditions.

Welding tents can be used for pipeline welding, oil and gas, mine sites, on-site welding and repairs, and electrical servicing.

SPECIFICATIONS

- Can be closed at both the front and back.
- Sides are 2 m high with a ridge 2.2 m high.
- Made from matt white 570 gr/m² PVC fabric with reflective sideband.
- The PVC fabric is self-extinguishing and conforms to French M1 standards
- Fitted with an all-round 200 mm mud spat protection skirt

GAS HOSE ASSEMBLIES



- 5mm reinforced rubber gas hose
- Manufactured to Australian Standard.
- Available with “screw in fittings” if requested.

- AS/NZS 1869 C certification approved.
- AS1335-1995

Part No.	Description
Oxy/Acetylene Hose	
AS/OA5MM-5	5 m Cut/Coupled 5 mm
AS-OA5MM-10	10 m Cut/Coupled 5 mm
AS/OA10MM-10	10 m Cut/Coupled 10 mm
AS/OA5MM-15	15 m Cut/Coupled 5 mm
AS/OA5MM-20	20 m Cut/Coupled 5 mm
AS/OA5MM-30M	30 m Cut/Coupled 5 mm
AS/OA5-100	100 m Twin Hose 5 mm
AS/OA10-100	100 m Twin Hose 10 mm
Oxy/LPG Hose	
LPG5/OXY5MM-5	5 m Cut/Coupled 5 mm
LPG5/OXY5MM-10	10 m Cut/Coupled 5 mm
LPG5/OXY5MM-15	15 m Cut/Coupled 5 mm
LPG5/OXY5MM-20	20 m Cut/Coupled 5 mm
LPG5/OXY5-100	100 m Single 5 mm
LPG10/OXY10-100	100 m Single 10 mm

Part No.	Description
LPG Hose	
LPG5-100	100 m Single 5 mm
LPG10-100	100 m Single 10 mm
5MLPG	5 m Single
10MLPG	10 m Single
15MLPG	15 m Single
Argon Hose	
ARG5-10	10 m Single 5 mm
ARG5-30	30 m Single 5 mm
ARG5-100	100 m Single 5 mm
Acetylene Hose	
ACET5-100	100 m Single 5 mm
ACET10-100	100 m Single 10 mm
Oxy Hose	
OXY5-100	100 m Single 5 mm
OXY10-100	100 m Single 10 mm