

YOUR NEAREST TRADESMART MEMBER IS:



See back page for store locations

WWW.TRADESMART.NET.AU

1ST MAY 2020 - 31ST JULY 2020



# TAX TIME \$SAVINGS

P/N: FF70  
**FAN FORCED DIESEL SPACE HEATER**

P/N: SCMT22210  
**14 PCE METRIC RING & OPEN END SPANNER SET**

P/N: SV1AWG  
**WELDING GOGGLES (AUTO DARKENING)**

TradeSmart  
**MATES RATES!**



**LAVOR**  
SIMPLY STRONGER

- Fan forced diesel heater (21KW, 70000 BTU)
- Heating area capacity 160m2 (approx.)
- Fuel tank capacity 19lt.
- Diesel consumption 2.1 LPH (9 hrs)
- Thermostat control for maximum efficiency

- Lifetime Warranty
- Metric sizes from 6mm to 19mm
- Bonus – Imperial sizes from 1/4" to 1"



- MIG / TIG / ARC / PLASMA OXY CUTTING & GRINDING applications.
- Ideal for confined space work / mobile welding.
- Bump cap for head protection.
- Fire retardant hood for protection.
- Soft Silicone lined goggles for user comfort.
- Detachable mask.
- Comes with its' own carry bag.

# WIN THE ULTIMATE GIVEAWAY

FOR DETAILS SEE PAGES 2 & 3\*

TradeSmart  
**5 PACKS TO BE WON**



Nothing but **HEAVY DUTY.**



T&Cs APPLY

Images for illustration purposes only



# WHEN HEAVY DUTY MATTERS!

POWER TOOLS



Nothing but **HEAVY DUTY™**



**M18 FUEL™ 230 MM CUT-OFF SAW W/ ONE-KEY™**  
M18COS230-0



**\$879.00**  
GREAT BUY!

ONE-KEY™



**56 PCE RATCHET & SOCKET SET SAE & METRIC 3/8 DR**  
48229008 + BONUS 48222706 6 PCE SCREWDRIVER KIT



**\$229.00**  
GREAT BUY!

TradeSmart  
**BONUS**  
48222706  
6 PCE  
SCREWDRIVER  
KIT



**PACKOUT™ COMPACT TOOL BOX**  
48228422



**\$159.00**  
GREAT BUY!

## WIN

**THE ULTIMATE TRADIE PACK**  
VALUED AT OVER **\$6000** RRP

- SPEND \$300 OR MORE ON ANY MILWAUKEE PRODUCTS AT ANY TRADESMART MEMBER AND GO INTO THE DRAW TO WIN \$6K WORTH OF GEAR
- SHOP IN STORE, ENTER ONLINE AT [TRADESMART.NET.AU](http://TRADESMART.NET.AU) AND FILL IN YOUR DETAILS FOR YOUR CHANCE TO WIN!

Terms and Conditions apply.

TradeSmart  
**5 PACKS TO BE WON**



**M18 FUEL™ 4 PIECE POWER PACK 4B2**

M18FPP4B2-502B

**\$1399.00**  
GREAT BUY!



TradeSmart  
**BONUS**  
48228301  
PACKOUT™  
BACKPACK

**M12 FUEL™ 1/2" STUBBY IMPACT WRENCH W/ FRICTION RING**

M12FIWF12-0

TradeSmart  
**BONUS**  
48228122  
3 TIER MATERIAL  
POUCH



**\$269.00**  
GREAT BUY!

**M18 FUEL™ 3 PIECE POWER PACK 3A2**

M18FPP3A2-502B



TradeSmart  
**BONUS**  
M18B5  
M18™ 5.0AH  
REDLITHIUM™-ION  
BATTERY

**\$949.00**  
GREAT BUY!



**NOW AVAILABLE!**

OFFER ENDS 31ST JULY 2020







Nothing but **HEAVY DUTY**.™



**AUTHORISED  
RETAIL PARTNER**



Images for illustration purposes only

**M18 FUEL™ 305MM DUAL BEVEL SLIDING COMPOUND MITRE SAW WITH ONE-KEY™**  
M18FMS305-0

**\$1349.00**  
GREAT BUY!

**BONUS M18™ REDLITHIUM™-ION HIGH OUTPUT 12.0AH STARTER PACK M18HOSP-121B VIA REDEMPTION\***  
\*ONLY AVAILABLE FROM APRIL 1<sup>ST</sup> - JUN 30<sup>TH</sup> 2020



ONE-KEY



**PACKOUT™ ROLLING TOOL BOX**  
48228426

**\$359.00**  
GREAT BUY!



**BONUS MILWAUKEE JOBSITE COOLER 48228250 VIA REDEMPTION\***  
\*ONLY AVAILABLE FROM APRIL 1<sup>ST</sup> - JUN 30<sup>TH</sup> 2020

**M18 FUEL™ 6 PIECE POWER PACK 6A2**  
M18FPP6A2-503B

**\$1629.00**  
GREAT BUY!



**BONUS DARCHÉ® 4WD AWNING VIA REDEMPTION\***  
\*ONLY AVAILABLE FROM APRIL 1<sup>ST</sup> - JUN 30<sup>TH</sup> 2020

**M18 FUEL™ ONE-KEY™ HIGH TORQUE IMPACT WRENCH 3/4" W/ FRICTION RING**  
M18ONEFHIWF34-0

**\$559.00**  
GREAT BUY!

ONE-KEY

**TradeSmart!**  
**BONUS**  
48228030  
JOBSITE  
ORGANISER 20"



**M12 FUEL™ 3/8" STUBBY IMPACT WRENCH KIT**  
M12FIW38-202B

**\$429.00**  
GREAT BUY!

**BONUS 38 PIECE SOCKET & BIT SET 48229599 VIA REDEMPTION\***  
\*ONLY AVAILABLE FROM APRIL 1<sup>ST</sup> - JUN 30<sup>TH</sup> 2020



**M18 FUEL™ 2 PIECE POWER PACK 2A2**  
M18FPP2A2-502C

**\$669.00**  
GREAT BUY!

**BONUS M18 FUEL™ HACKZALL™ RECIPROCATING SAW M18FHZ-0 VIA REDEMPTION\***  
\*ONLY AVAILABLE FROM APRIL 1<sup>ST</sup> - JUN 30<sup>TH</sup> 2020



**AUTHORISED  
RETAIL PARTNER**

\*Terms and Conditions apply, see website for details. \*Offers valid during the promotional period 1st April 2020 - 30th June 2020.

\*Online redemption must be claimed by 14th July 2020. \*Please allow up to 8 weeks for delivery.



FREIGHT CHARGES MAY APPLY





# HOT DEALS STOREWIDE!

## CUTTING/DRILLING

# suttontools TOOL DEALS YOU NEED



### 25 Pce Blue or Bright Drill Set + BONUS Shaviv Mango II Debiting Handle

Drill Sizes: 1.0 – 13.0mm x 0.5mm  
**BONUS Shaviv Mango II Handle**  
 The most recommended handle for comfort and control in deburring Deburrs Steel, Aluminium, Copper, Brass, Cast Iron and Plastics.

**Blue Drills**  
**\$14900**  
INC GST  
 P/N: D102 SM3M60

**Bright Drills**  
**\$14900**  
INC GST  
 P/N: D101 SM3M60



**SILVER BULLET**  
 TWIST DRILLS

### 25 Pce Silver Bullet Metal Drill Set - Metric

• 1.0 - 13.0mm x 0.5

**\$16900**  
INC GST  
 P/N: D101 MTL5M3



**SILVER BULLET**  
 TWIST DRILLS

### 29 Pce Silver Bullet Metal Drill Set - Imperial

• 1/16 - 1/2 x 64ths

**\$18900**  
INC GST  
 P/N: D101 MTL53



### 8 Pce Reduced Shank Drill Set

- Precision ground flute, bright cutting edge with blue flute
- 14 - 25mm x 12.5mm shanks

**\$39900**  
INC GST  
 P/N: D188 SM8R



### HSS Step Drill

For use in sheet metal, aluminium, plastic and fibreglass. During drilling, the next step deburrs the previously drilled hole.

Size	Steps	Item #	Price Inc. GST
1/8"-1/2"	13	D504 31313	<b>\$39.95</b>
4-12	5	D504 41205	<b>\$34.95</b>
4-12	9	D504 41209	<b>\$27.95</b>
4-20	9	D504 42009	<b>\$54.95</b>
4-22	10	D504 42210	<b>\$79.00</b>
4-30	14	D504 43014	<b>\$119.00</b>
3/16"-1/2"	6	D504 51306	<b>\$34.95</b>
5-35	13	D504 53513	<b>\$155.00</b>
6-18	7	D504 61807	<b>\$49.95</b>
1/4"-3/4"	9	D504 61909	<b>\$58.95</b>
6-36	11	D504 63611	<b>\$169.00</b>



### 6 Pce Electrician Heavy Duty Bi-Metal Holesaw Set

- Holesaw sizes: 16, 20, 25, 32, 40 & 51mm

**\$8900**  
INC GST  
 P/N: H125 S9



### 11 Pce Maintenance Heavy Duty Bi-Metal Holesaw Set

- Holesaw sizes: 19, 22, 25, 32, 35, 38, 44, 51, 57, 63 & 76mm

**\$15900**  
INC GST  
 P/N: H125 S14



### 10 Pce Easy-Out Screw Extractor Set

- Sizes: #1 - #5
- Includes left hand cobalt jobber drills: 2.0, 3.0, 4.0, 5.5, 7.5mm

**\$6995**  
INC GST  
 P/N: M603 S20L



### 10 Pce Bolt Extractor Insert Set

- 8, 9, 10, 11 & 12mm inserts suits 14mm wrench
- 13, 14, 15, 16 & 17mm inserts suits 19mm wrench

**\$5900**  
INC GST  
 P/N: M604 0817



# SHOP SMART - BUY SMART!

## CUTTING/DRILLING

# 125 x 1.0 mm

### Ultra-Thin Cut-Off Wheel

# X TREME

Cutting Performance

Save time & money  
Wheel lasts longer  
Consistent quality  
Reduced burr  
Made in Germany

**Premium Ultra-Thin Cut-Off Wheel**

Size: 125mm (5")  
Article Number: 61341112



Steel

Stainless Steel (INOX)



Also suitable for cordless angle grinders



**\$2.50**

GREAT VALUE!

# ACTIROX

## MAXIMUM STOCK REMOVAL.



VSM ceramic grain  
Made in Germany

**ACTIROX STEEL Fibre Disc**

Size: AF799 125mm (5") 36 Grit  
Article Number: 75485211

Recommended for STEEL,  
also suitable for Stainless Steel (INOX)

The new generation grinding disc  
Low pressure required when grinding  
Best when used with a high performance backing pad

**High Performance Backing Pad**

Size: 125mm (5")  
Article Number: 44890090

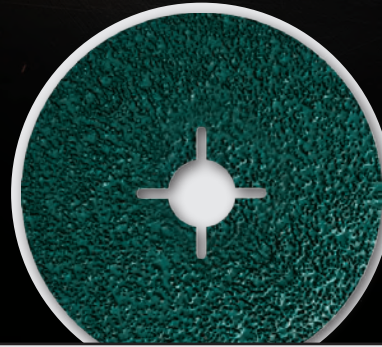

**\$26.95**

## flexOvit



## NORTON

SAINT-GOBAIN

Reshaping your world.

### FLEXOVIT MEGA-LINE Cut Off Wheel



**\$220** EACH  
GREAT VALUE!

66253371090 125 x 1.0 x 22.23mm

- Ultra thin cutting of steel & stainless
- Fast straight cutting & long life

### FLEXOVIT ION CORDLESS UTG DC Grinding Wheel



**\$395** EACH  
GREAT VALUE!

66253371769 125 x 3.0 x 22.23mm

- Formulated for cordless angle grinders
- Offering comfort, stability & precision

### FLEXOVIT MM UTG DC Grinding Wheel



**\$375** EACH  
GREAT VALUE!

66253371768 125 x 3.0 x 22.23mm

- Premium grade for grinding stainless steel, metal, masonry, aluminium, PVC, tiles and rubber



### NORTON MM Diamond Blade



**\$2895** EACH  
GREAT VALUE!

70184602109 125 x 22.23/20.0mm

- Used on angle grinders
- For cutting steel, stainless, masonry, aluminium, PVC, tiles and rubber

### NORTON QUANTUM UT Turbo Diamond Blade



**\$2595** EACH  
GREAT VALUE!

70184601303 125 x 1.2 x 22.23mm

- Ideal for cutting concrete, masonry, stone, paving and cement bricks

### NORTON ESSENTIAL Turbo Diamond Blade



**\$2995** EACH  
VALUE OPTION

70184601091 230 x 2.6 x 10 x 25.4/22.2mm

- Fast and smooth cutting of concrete, slate, bricks, pavers, tiles, plastic pipes, granite etc.

### BEAR GRIZZLY Gaffer Tape



**\$595** EACH  
GREAT VALUE!

63642548168 50mm x 9 metre - Black

63642548169 50mm x 9 metre - Silver

- For use in multiple applications
- Sticks like...no other

Flexovit, Norton and Bear are registered trademarks of Saint-Gobain Abrasives, Pty. Ltd.



TOOLS

**KINCROME**  
PROFESSIONAL QUALITY TOOLS

TRUST TOUGH

# Deluxe DEALS

**\$299**

**SUPER DEAL!**



**KINCROME**  
**PORTABLE TOOLKIT**  
96 PIECE

- 15 Metric Sockets • 11 Imperial Sockets
- 5 Socket Accessories • TorqueMaster® Screwdrivers
- Hex Keys • Spanners & much more...

K1850



**\$299**

**HOT PRICE!**



**KINCROME**  
**PORTABLE TOOLKIT**  
120 PIECE

- 17 Metric Sockets • 6 Socket Accessories
- TorqueMaster® Screwdrivers
- Hex Keys • Spanners & much more...

K1855



**\$2099**

**GREAT VALUE!**

**KINCROME EVOLUTION**

**TOOL CHEST**

281 PIECE 7 DRAWER

- 92 Piece Sockets & Accessories
- Pliers • Hex Keys
- Spanners & much more...



K1218



**\$1699**

**BARGAIN BUY!**

**KINCROME EVOLUTION**

**TOOL TROLLEY**

232 PIECE 7 DRAWER

- 92 Piece Sockets & Accessories
- Pliers • Hex Keys
- Spanners & much more...



K1630



**\$2399**

**SUPER DEAL!**

**KINCROME CONTOUR**

**WORKSHOP TOOLKIT**

208 PIECE 14 DRAWER

- 92 Piece Sockets & Accessories
- Pliers • Hex Keys
- Spanners & much more...



K1510



**\$3699**

**HOT PRICE!**

**KINCROME EVOLUTION**

**WORKSHOP TOOLKIT**

466 PIECE 14 DRAWER

- 92 Piece Sockets & Accessories
- Pliers • Hex Keys
- Spanners & much more...



K1228



**Alpha**

**8 PIECE | DEMOLITION SET**

Contains: 8x  
Destructor Recip Blades



**\$49<sup>95</sup>**

RD-SET8T

**THUNDER ZONE**

10 PCE IMPACT BIT SET



Engineered spiral torsion zone, distributes the applied impact evenly throughout the torsion zone

**\$17<sup>95</sup>**

TBS10

**4 PIECE | MULTI-TOOL BLADE SET**

The perfect starter kits to cut a wide range of materials.



**\$39<sup>95</sup>**

H4MAK

**BRISTOL**  
tool works

**STEP DRILL | 3 PIECE SET**

- Contains: 3 sizes
- 4-12mm
- 4-20mm
- 6-30mm
- Drills: Sheet metal, steel & plastic
- Cut depth: Up to 4mm



**\$59<sup>95</sup>**

BTWSD-SET3

**Sterling**

**BLACK PANTHER GEN II INDUSTRIAL SNIPS**

- Ideal knife replacement tool featuring quality stainless steel, giving them a constant sharp edge and corrosion resistance in industrial environments.

- Upgraded locking clasp with comfort grip
- Ideal for various applications including: Wire, aluminium, sheet metal, carpet, leather, rubber, gardening, food prep, camping and more



200mm

**\$28<sup>95</sup>**

29-720

185mm

**\$24<sup>95</sup>**

29-721

185mm  
High Tensile

**\$37<sup>95</sup>**

29-722

**Ultimax EASYREAD TAPE MEASURE**

**Ultimax TAPE MEASURE**

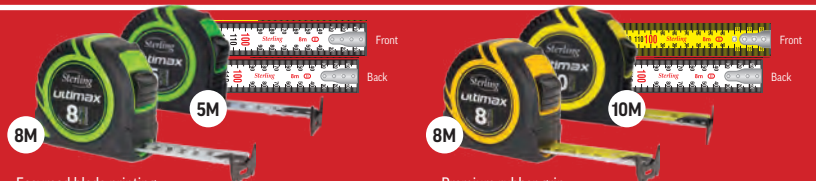

- Easyread blade printing
- Double sided blade printing
- High impact resistant ABS casing with non-slip grip
- Reinforced 4 rivet dual-hook

- Premium rubber grip
- Double sided blade printing
- High impact resistant ABS casing with non-slip grip
- Reinforced 4 rivet dual-hook

CODE	DESCRIPTION	PRICE (inc GST)
TMXE5019	5m x 19mm Metric Easyread	\$9.95
TMXE8025	8m x 25mm Metric Easyread	\$15.95

CODE	DESCRIPTION	PRICE (inc GST)
TMX8025	8m x 25mm Metric	\$15.95
TMX1025	10m x 25mm Metric	\$24.95

A family business built upon  
**TRUST, INNOVATION**  
**QUALITY & RELIABILITY**

**BREMICK™**



# SIDCHROME®



7 DRAWER ROLLER CABINET  
SCMT50207

**\$599.00**  
HOT BUY!



162 PIECE MET A/F TOOL KIT TOP CHEST  
SCMT11700

**\$999.00**  
HOT BUY!



13 DRAWER WIDEBODY ROLLER CABINET  
SCMT50224

**\$1249.00**  
HOT BUY!



**BONUS**

SIDCHROME 10 DRAWER EXTRA DEEP TOP CHEST  
SCMT50200



HEAVY DUTY CONTRACTORS BAG  
SCMT50005

**\$69.00**  
GREAT VALUE!



SIDCHROME 38 PCE METRIC 1/4" DRIVE NANO SOCKET SET  
SCMT12120

**\$94.00**  
GREAT VALUE!



68 PCE 3/8" DRIVE TOOL SET  
SCMT13115

**\$279.00**  
GREAT VALUE!



24 PCE METRIC/AF 1/2" DRIVE SOCKET SET  
SCMT14110

**\$139.00**  
GREAT VALUE!



32 PCE METRIC/AF 3/8" DRIVE SOCKET SET  
SCMT13105

**\$179.00**  
GREAT VALUE!



64 PCE METRIC/AF 1/4", 3/8", 1/2" DRIVE SOCKET SET  
SCMT19120

**\$269.00**  
GREAT VALUE!



SIDCHROME 7 PIECE METRIC 1/2" DRIVE INHEX SOCKET SET  
SCMT14274

**\$79.00**  
HOT BUY!

**BONUS**

SIDCHROME 9 PCE AF 1/2" DRIVE INHEX SOCKET SET  
SCMT14465



14 PCE METRIC RING & OPEN END SPANNER SET  
SCMT22210

**\$129.00**  
HOT BUY!

**BONUS**

13 PCE AF RING & OPEN END SPANNER  
SCMT22410



## ANTI-VIBRATION SOLUTIONS



MULTICUSHIONS

MOBILE TWO PIECE

PLATE ISOLATORS

VEE MOUNTS

CONFLEX ISOLATORS





TOOLS

suttontools

TOOL DEALS YOU NEED

**FN** WORKSHOP



**3 Pce HSS Countersink Set**

- For use in steel, cast iron, brass & aluminium.
- Contains: 8.3, 12.4 & 20.5mm

**\$4995**  
INC GST  
P/N: 107CS0003



**Outside Micrometer**

- Measuring range: 0-25mm
- Graduations: 0.01mm
- Accuracy: ±0.004mm

**\$6995**  
INC GST  
P/N: 267MCS025

**Thread Gauges**

- Clamping screws for holding the blades
- Made with precision milled teeth



Description	Blades	Item #	Price Inc. GST
Metric (60°) & Pipe (BSP 55°)	30	268MG0030	<b>\$24.95</b>
Metric (60°) & Whitworth (55°)	52	268MW0052	<b>\$24.95</b>
UNC (60°) 4-64 TPI (22 Blades)	22	268UNC022	<b>\$19.95</b>
UNF (60°) 12-80 TPI (16 Blades)	16	268UNF016	<b>\$18.95</b>



**Combination Square 3 in 1**

- Size: 300mm
- Mitre square, spirit level, plumb level, 45° level, height gauge, steel rule, straight edge & scriber

**\$9900**  
INC GST  
P/N: 267CS3030



**Auto Centre Punch**

- Made from brass
- Spring loaded, no hammer required

**\$1995**  
INC GST  
P/N: 267AP1125



**Engineer Squares**

- Made from stainless steel
- Carbon steel handle
- Precision 90°
- 1mm graduations

Size	Item #	Price Inc. GST
100mm Graduated	2675G1004	<b>\$22.95</b>
150mm Graduated	2675G1006	<b>\$32.95</b>
200mm Graduated	2675G1008	<b>\$42.95</b>

**LOCKJAW**

**One Hand Aluminium Clamp**

Heavy duty design for industrial & professional application. Aluminium alloy clamp body to withstand great clamp pressure. Maximum clamping force up to 350kgs.

Diameter	Item #	Price Inc. GST
150 mm	L110 0150	<b>\$45.95</b>
300 mm	L110 0300	<b>\$49.95</b>
450 mm	L110 0450	<b>\$54.95</b>
600 mm	L110 0600	<b>\$59.95</b>



**3 Pce Self-Adjusting Pliers**  
Contains: 175mm Curved Jaw, 250mm Curved Jaw & 200mm Needle Nose

**\$9900**  
INC GST  
P/N: L293 0001

**CHANNEL LOCK**



**Cutting Insulated Pliers**

Insulated to 1000V, these pliers are ideal for electrical tradespeople.

**\$6495**  
INC GST  
P/N: 3238

**INSULATED TO 1000V**



**Linesman's Insulated Pliers**

Insulated to 1000V, these pliers are ideal for electrical tradespeople.

**\$6495**  
INC GST  
P/N: 3248



**BONDHUS**

**9 Pce Metric Ball End L-Wrench**

- 1.5, 2, 2.5, 3, 4, 5, 6, 8 & 10mm

**\$3495**  
INC GST  
P/N: 10999



**13 Pce Imperial Ball End L-Wrench**

- 0.050 - 3/8"

**\$4195**  
INC GST  
P/N: 10937



**Venom Cutting Lubricants**

- Lowest torque required for higher performance
- Reduced friction for extremely high quality surface finish
- Extends tool life



Size	Item #	Price Inc. GST
Fluid 250ml	M800 0250	<b>\$13.95</b>
Paste 400g	M800 0400	<b>\$29.95</b>
Spray 300g*	M800 0300	<b>\$17.95</b>

\*Min. order qty 6





### RENNSTEIG

Made in Germany

### HIT

PROFESSIONAL TOOLS

MADE IN JAPAN

## Crowbars

- Heavy duty crowbars suitable for all demolition, carpentry and construction work
- High-quality tool steel with black powder coated finish

PRICED FROM...  
**\$165<sup>00</sup>**



Part No.	Edge	Tip	Length m	Weight Kg	PRICE
2731 1500	Curved Edge	Pointed Tip	1.5	7.95	\$165.00
2732 1500	Straight Edge	Pointed Tip	1.5	7.91	\$165.00
2734 1500	Curved Claw Edge	Pointed Tip	1.5	7.92	\$165.00
2735 1500	Straight Edge	Ball Tip	1.5	8.6	\$239.00

## Belt Strap Wrenches

Nylon & Nylon Rubber Lined

- Strong woven nylon strap with special coating provides a strong grip even in oily conditions
- Suitable for use on steel, plastic and glass pipes, PVC conduit, and tapware



Part No.	Strap Type	Handle Length mm	Belt Length mm	Capacity mm	Price
HITBTW3	Nylon	300	400	15 - 75	\$59.95
HITBTW6	Nylon	300	700	15 - 165	\$69.95
HITBTW14	Nylon	300	1400	15 - 250	\$99.00
HITBTW3G	Nylon & Rubber	300	400	15 - 75	\$76.95
HITBTW6G	Nylon & Rubber	300	700	15 - 165	\$99.00

## Ratchet Pipe Cutters

- Easy cutting of PVC and other plastic pipes
- Ratchet shear permits smooth and easy operation
- HITVPC42 - includes cutting guide for precise angle cuts



Part No.	Length mm	Cutting Capacity mm	Weight Kg	Price
HITVPC34	200	26	0.29	\$49.95
HITVPC42	250	42	0.35	\$67.95

## KINCROME

PROFESSIONAL QUALITY TOOLS

TRUST TOUGH

# Deluxe DEALS

**\$4195**  
EACH

BARGAIN BUY!



KINCROME  
KEY WRENCH SETS  
9 PIECE

METRIC	1.5 - 10mm	K5043
IMPERIAL	1/16 - 3/8"	K5042
TORX®	T10 - T50	K5009
T/PROOF TORX®	T10H - T50H	K5044

**\$105<sup>00</sup>**

HOT PRICE!



KINCROME  
SCREWDRIVER SET  
13 PIECE TORQUEMASTER

- 8 BLADE 3 x 75mm - 9.5 x 250mm
- 5 PHILLIPS No.0 x 75mm - No.3 x 150mm

32064



**\$99<sup>00</sup>**

SUPER DEAL!



KINCROME  
SINGLE WAY GEAR SPANNER SETS  
8 PIECE

- 8 METRIC 8 - 19mm

K3100



**\$209<sup>00</sup>**

HOT PRICE!



KINCROME  
SOCKET SET  
42 PIECE 1/2" DRIVE

- 19 METRIC Sockets: 8 - 32mm
- 15 IMPERIAL Sockets: 3/8 - 1.1/4"
- 8 Accessories

K28022



**\$105<sup>00</sup>**

GREAT VALUE!



KINCROME  
HEX IMPACT SOCKET SET  
10 PIECE 1/2" DRIVE

- 10 Hex Impact Sockets: 5, 6, 7, 8, 9, 10, 12, 14, 17, 19mm
- EVA Tray for storage

K28210



**\$149<sup>00</sup>**

BARGAIN BUY!



KINCROME  
REVERSIBLE GEAR SPANNER SET  
8 PIECE

- 8 METRIC 8 - 19mm

K3017





# FOLLOW US ON FACEBOOK



FACEBOOK.COM/TRADESMARTINDUSTRIAL

## WORKSHOP

Powering the Nation  
Since 1936



dunlite.com.au



**UNBEATABLE!**  
**\$999**

DGUH2.7S-2  
**3.3 kVA HONDA POWERED GENERATOR**

- Honda GX200 engine • Italian NSM Alternator
- Small, light, durable & powerful
- Makes light work of the trickiest jobs!



**BEST SELLER**  
**\$2199**

DGUH7S-2  
**8 kVA HONDA POWERED GENERATOR**

- Honda GX390 engine • Popular choice & great all-rounder!
- Handy for the farm or building site



**SUPER SPECIAL**  
**\$2649**

DGWH7S-2  
**7 kVA 200 AMP WELDER GENERATOR**

- Honda GX390 engine • 200 Amp welder • 60% duty cycle • 12 & 24V battery charger



**GREAT VALUE!**  
**\$2399**

EF2400iS  
**YAMAHA 2.4 kVA INVERTER GENERATOR**

- Safe for sensitive electronics • Independent fuel tap & fuel gauge • Silent operation • 4 years warranty



**BAHCO**



**PROFESSIONAL HEAVY DUTY HACKSAW FRAME 300MM (12")**

- High blade tension for accurate and exact kerf
- Can be used as a compass saw
- Alternative 55° blade mounting for flush cutting

**\$35<sup>95</sup>**  
**GREAT VALUE**



**4 PIECE REVERSIBLE RATCHET SPANNER SET PN: S4RM/4T**  
Sizes in set: 8, 9, 10, 11mm / 12, 13, 14, 15mm / 16, 17, 18, 19mm / 21, 22, 24, 27mm

**\$129<sup>00</sup>**  
**GREAT VALUE**

- 4 in 1 ratcheting wrenches
- Set is in practical pouch to carry on your belt



**5 PIECE SCREWDRIVER SET PN: B219.005**  
3 x Slotted - 3.0 x 75, 4.0 x 100, 5.5 x 125, 2x Phillips PH1 x 100, PH2 x 125 - BahcoFit

- Comfortable 2 component handle
- High performance alloy steel shaft and black tip

**\$34<sup>95</sup>**  
**GREAT VALUE**

**3 PIECE ADJUSTABLE WRENCH SET PN: ADJUST 3-90**  
Sizes 6" / 8" and 10"



- High performance alloy steel
- Comfortable non-slip thermoplastic grip handle

**\$129<sup>00</sup>**  
**GREAT VALUE**

## RICHMOND WHEEL & CASTOR CO

**YOUR NUMBER ONE CHOICE FOR WHEELS, CASTORS, AND MORE!**

### 600 X 450MM RUBBER DECK FURNITURE DOLLIE

- Slip-resistant rubber deck
- Rebound rubber wheels

**\$85<sup>00</sup>**  
INC GST  
P/N: SKR006



UP TO 400KG

### 700 X 500MM RUBBER DECK FURNITURE DOLLIE

- Slip-resistant rubber deck
- Rebound rubber wheels

**\$95<sup>00</sup>**  
INC GST  
P/N: SKR007



UP TO 400KG

### SAFETY STEP

- 505 x 505 x 365mm dimensions
- 250kg safe working load

**\$79<sup>00</sup>**  
INC GST  
P/N: SSR002



### ROLLING SAFETY STEP INSERT

- Spring loaded castors safely retract when weight is applied

**\$32<sup>95</sup>**  
INC GST  
P/N: SSR003

### PRAM HANDLE TROLLEY WITH PNEUMATIC WHEELS

- Easy rolling pneumatic wheels
- 1300 x 540mm frame size
- 200kg capacity

**\$209** INC GST  
P/N: PRR125



### PRAM HANDLE TROLLEY WITH PUNCTURE PROOF WHEELS

- No more flats! Puncture proof wheels prevent flat tyres
- 1300 x 540mm frame size
- 200kg capacity

**\$219** INC GST  
P/N: PRR124

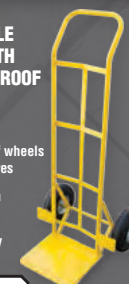

### STANDARD YELLOW PALLET JACK

- 85mm min and 200mm max fork height
- Strong, reinforced steel construction
- Easy access entry and exit rollers
- 680mm overall fork width

**\$419** INC GST  
P/N: PJR001Y



2500KG SAFE WORKING LOAD

HIGH QUALITY HYDRAULICS

### 215MM STEEL CENTRE PUNCTURE PROOF WHEEL

- 55mm Tyre Width
- 2.50-4 Tyre Size
- 3/4" Axle



**\$35<sup>95</sup>** INC GST  
P/N: PF8881-75

UP TO 100KG

### 255MM STEEL CENTRE PUNCTURE PROOF WHEEL

- 83mm Tyre Width
- 4.10/3.50-4 Tyre Size
- 3/4" Axle



**\$51<sup>95</sup>** INC GST  
P/N: PF1084-75

UP TO 100KG

### 400MM STEEL CENTRE PUNCTURE PROOF WHEEL

- 93mm Tyre Width
- 4.00-8 Tyre Size
- 1" Axle



**\$89<sup>00</sup>** INC GST  
P/N: PF1632-1

UP TO 200KG



**HOT DEALS | PRODUCT LAUNCHES | INDUSTRY UPDATES | HELPFUL HINTS**

**SAFETY**

**PARAMOUNT**  
SAFETY PRODUCTS

**PRO**  
PRO CHOICE SAFETY GEAR

**PRATT**  
SAFETY SYSTEMS

**MEDIQ**  
THE SMART CHOICE IN FIRST AID

**THORZT**  
HYDRATING HARD WORK



**\$5<sup>95</sup>**  
GREAT VALUE!

**9903**

**9903 SAFETY GLASSES**

- Medium Impact rated
- 99.9% UV protection for outdoor wear
- Anti-scratch lens coating



**\$14<sup>95</sup>**  
GREAT VALUE!

**TGP-(SIZE)**

**THERMOGRIP GLOVES & LINER**

- Excellent protection in cold weather
- Sand grip provides superior gripping power
- Sizes: 8, 9, 10, 11



**\$1,799**  
GREAT VALUE!

**5545AS**

**FLAMMABLE LIQUID STORAGE CABINET - 250L**

- Double walled 1.2mm galvanised steel
- 2 x sequential self closing doors



**\$21<sup>95</sup>**  
GREAT VALUE!

**FSZ15**

**ZEOLITE FLOOR SWEEP - 15L**

- All natural heat sterilised mineral
- Absorbs immediately on contact
- De-dusted to reduce surface bogging



**\$9<sup>95</sup>**  
GREAT VALUE!

**7008**

**TYPHOON SAFETY GLASSES**

- Medium Impact rated
- 99.9% UV protection for outdoor wear
- Anti-fog & anti-scratch lens coating



**\$16<sup>95</sup>**  
GREAT VALUE!

**HHV92R-FY HHV92R-FO**

**V9 VENTED TYPE 2 HARD HAT**

- Type 2 high temperature polycarbonate
- 6 point 25mm webbing ratchet harness
- Fits all head sizes: 53cm - 66cm



**\$1,299**  
GREAT VALUE!

**X-5512PSPH**

**CORROSIVE POLYETHYLENE STORAGE CABINET - 20L**

- 19mm polypropylene plastic panels
- Small bench top design



**\$129<sup>00</sup>**  
GREAT VALUE!

**FAMKS**

**INCIDENT READY KIT SOFT PACK**

- 5 individually packed modules: Burns, Eye, Haemorrhage, Minor Wounds, Outdoor/ Snake/Spider



**\$5<sup>95</sup>**  
GREAT VALUE!

**WT6LIN-(SIZE)**

**TAEK15 LINER GLOVES**

- High contact heat protection - up to 250°C
- Stretchable & breathable material
- Sizes: 8, 9, 10, 11



**\$2<sup>95</sup>**  
GREAT VALUE!

**LSO**

**LEADSAFE**

- Designed to keep leads, cables & electrical cords away from danger zones while you are using them



**\$1,399**  
GREAT VALUE!

**SE607**

**COMBO SHOWER - TRIPLE NOZZLE EYE & FACE WASH WITH BOWL & FOOT TREADLE**

- SHOWER HEAD
- EYE-FACE WASH NOZZLES
- FOOT TREADLE



**\$69<sup>00</sup>**  
GREAT VALUE!

**BP25B**

**2L HYDRATION BACKPACK**

- Velcro tabbed protective cover
- 3 waterproof zip pockets
- Neoprene insulated hydration tube



**\$4<sup>95</sup>**  
GREAT VALUE!

**CGL41NSB-(SIZE)**

**RIGGAMATE COW SPLIT BACK GLOVES**

- Premium cow grain leather palm
- Outstanding durability & comfort
- Sizes: S, M, L, XL, 2XL



**\$12<sup>95</sup>**  
GREAT VALUE!

**FSPYCIP FSPYSWW**

**FLOOR STANDS**

- A-frame self-standing
- Folds flat for easy storage
- 600mm high x 300mm wide



**\$69<sup>00</sup>**  
GREAT VALUE!

**BP25Y**

**3L HYDRATION BACKPACK**

- Velcro tabbed protective cover
- Fully adjustable straps
- Neoprene insulated hydration tube







# TAX TIME SAVINGS

## PREMIUM HAND PROTECTION



### NINJA HPT GRIPX GLOVES

- Black Code: NIGRPXHPTBK  
Flouro Yellow Code: NIGRPXHPTFY
- Sizes XS-2XL
  - Provides superior grip in wet & oily environments



**\$4<sup>95</sup>**  
SPECIAL PRICE

### CONTEGO HYBRIDZ CUT 5 IMPACT GLOVES

- 360° Cut resistance with excellent impact & anti-vibration protection
- Sizes: S - 2XL  
Code: COHYBRIDZGY



**NEW**  
**\$24<sup>95</sup>**  
GREAT VALUE

Extra thumb crotch reinforcement

Breathable, flexible foam nitrile palm for comfort & fit

360° Cut resistance. Certified to Cut Level C. EN388:2016



Padded palm insert for extra protection from impact & vibration

soft and flexible TPR protects against blows or crush injury

### CONTEGO VERSADEX MULTI-PURPOSE GLOVES

- Black Code: COVDXMEKBB  
Grey Code: COVDXMEKGY
- Sizes S-2XL
  - Great tactility, water resistance & comfort
  - Ideal for general handling



**\$7<sup>95</sup>**  
SPECIAL PRICE

### GRIPPAZ DISPOSABLE GLOVES

- Black Code: GZGLVSKNSBK  
Orange Code: GZGLVSKNS00
- Sizes: M-2XL
  - Extra tough, latex & silicone free
  - Provides excellent grip



**\$24<sup>95</sup>**  
GREAT VALUE

BOX OF 100

## PREMIUM EYEWEAR

### MACK B-DOUBLE POLARISED SAFETY GLASSES

- Smoke Lens Code: MKBDOUBLES0000
- UV and glare resistant
  - Medium impact and scratch resistant



POLARISED LENS

**\$34<sup>95</sup>**  
SPECIAL PRICE

### MACK DUO SAFETY GLASSES

- Clear Lens Code: MKDUOSPECCR0000
- Smoke Lens Code: MKDUOSPECSM0000
- UV & medium impact resistant
  - Padded side arms and adjustable nose pads



CLEAR

**\$6<sup>95</sup>**  
SPECIAL PRICE



SMOKE

## PPE



### FRONTIER TAKT NITRILE FOAM GLOVES

- Code: FRMICRFMNBK
- Sizes S-2XL
  - Seamless nylon shell for enhanced movement
  - Excellent wet & dry grip



**\$2<sup>95</sup>**  
SPECIAL PRICE

### FRONTIER IGUANA CUT 5 NITRILE GLOVES

- Black Code: FRIGUANC5BK  
Flouro Yellow Code: FRIGUANC5FL
- Cut 5 protection & PU coat for excellent grip
  - Seamless shell for enhanced dexterity



**\$6<sup>95</sup>**  
SPECIAL PRICE

### FRONTIER CLARITY SAFETY GOGGLE - CLEAR

- Code: FRCLARGGLCR0000
- Chemical splash resistant
  - Anti-fog & anti-scratch coatings
  - Medium impact rated



**\$19<sup>95</sup>**  
GREAT VALUE!

### FRONTIER VISION X SAFETY GLASSES

- Clear Lens Code: FRVISXSPCCR0000
- Smoke Lens Code: FRVISXSPCSM0000
- Ultra lightweight tough polycarbonate frame
  - Anti-fog & anti-scratch lenses



**\$3<sup>95</sup>**  
GREAT VALUE!

CLEAR

SMOKE

### FRONTIER CLASS 5 OVERHEAD EARMUFFS - 30dB YELLOW

- Code: FREARMUFFY00C5
- High quality robust protection
  - High noise use



**\$19<sup>95</sup>**  
SPECIAL PRICE

### FRONTIER CLASS 5 UNCORDED FOAM EAR PLUGS

- Code: FREARPLUGY00C5R
- Retail Pack / 10 pairs
  - Soft PU memory foam



**\$3<sup>95</sup>**  
SPECIAL PRICE

### FRONTIER P2 DISPOSABLE FACE MASKS

- Code: FRRESPCUP0000P2
- Industrial grade & lightweight
  - No staples in bands



BOX OF 20

**\$24<sup>95</sup>**  
HOT PRICE

### FRONTIER P2 DISPOSABLE FACE MASKS - WITH VALVE

- Code: FRRESPCUP0000P2V
- Industrial grade with vent
  - No staples in bands



BOX OF 10

**\$19<sup>90</sup>**  
HOT PRICE



# SHOP SMART - BUY SMART

## CHEM/CASTORS



### 200 SERIES CASTORS

Perfect for all manner of light to medium duty applications

#### 80mm Nylon Wheel Castors

WHEEL DIAMETER: 80mm

LOAD CAPACITY: 125kg



<b>\$19<sup>95</sup></b> INC GST P/N: R3601	<b>\$20<sup>95</sup></b> INC GST P/N: S3600	<b>\$27<sup>95</sup></b> INC GST P/N: S3600B
---	---	--

#### 100mm Nylon Wheel Castors

WHEEL DIAMETER: 100mm

LOAD CAPACITY: 200kg



<b>\$21<sup>95</sup></b> INC GST P/N: R4601	<b>\$23<sup>95</sup></b> INC GST P/N: S4600	<b>\$29<sup>95</sup></b> INC GST P/N: S4600B
---	---	--

### HEAVY INDUSTRIAL CASTORS

High capacity castors designed to handle all kinds of heavy duty applications

#### 100mm Poly Tyred Cast Iron Castors

WHEEL DIAMETER: 100mm

LOAD CAPACITY: 250kg



<b>\$32<sup>95</sup></b> INC GST P/N: R4401	<b>\$34<sup>95</sup></b> INC GST P/N: S4400	<b>\$47<sup>95</sup></b> INC GST P/N: S4400SLB
---	---	--

#### 150mm Poly Tyred Cast Iron Castors

WHEEL DIAMETER: 150mm

LOAD CAPACITY: 250kg



<b>\$41<sup>95</sup></b> INC GST P/N: R6656	<b>\$44<sup>95</sup></b> INC GST P/N: S6655	<b>\$51<sup>95</sup></b> INC GST P/N: S6655SLB
---	---	--

#### HICHEM ETCH PRIMER

Size	Code	Price
400gm	EP400	\$12.95
400gm	SEP8400	\$12.95
1lt	SEP1	\$24.95
1lt	SEP81	\$24.95
4 lt	SEP4	\$79.00
4 lt	SEP84	\$79.00

400g Aerosols **HiChem**

#### HICHEM STRUCTURAL PRIMER

Size	Code	Price
400gm	3260G400	\$11.95
400gm	3260R400	\$11.95
1lt	3260G1	\$19.95
1lt	3260R1	\$19.95
4 lt	3260G4	\$49.95
4 lt	3260R4	\$49.95

400g Aerosols **HiChem**

#### HICHEM ENAMEL THINNER

Size	Code	Price
4 lt	E4	\$24.95
20 lt	E20	\$99



**HiChem**

#### MOTOSPRAY RUST CONVERTER

Size	Code	Price
250ml	RC250	\$17.95
500ml	RC500	\$29.95
1lt	RC1	\$44.95
4 lt	RC4	\$159.00



**RUST-OLEUM MOTOSPRAY**

#### MOTOSPRAY SUPER GLOW

Size	Code	Price
4 lt	SG4	\$24.95
20 lt	SG20	\$99

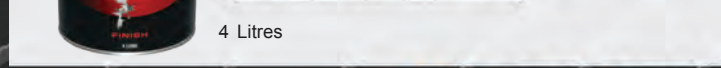

**RUST-OLEUM MOTOSPRAY**

**RUST-OLEUM**

#### WD-40 MULTI-USE PRODUCT TWIN TRADE PACK 425G Part No: 61564

- When you need to use a lot of WD-40 or work in a trade sometimes one can just isn't enough. That's why WD-40 is available in a twin pack!
- Cleans & protects chrome
- Lubricates chains on machines
- Penetrates stuck metal parts
- Releases rusted parts

**\$15<sup>95</sup>** GREAT VALUE!

#### WD-40 SPRAY APPLICATOR Part No: 61000

- 500mL capacity
- Refillable spout
- Child safety lock restraints
- Two ways to spray: stream or spray

**\$6<sup>95</sup>** GREAT VALUE!



#### WD-40 SPECIALIST SILICONE LUBRICANT Part No: 21001

- Prevents parts from sticking
- Waterproofs & protects against moisture
- For use on metal, plastic, rubber & wood



#### WD-40 MULTI-USE PRODUCT BULK LIQUID

**\$159<sup>00</sup>** GREAT VALUE! *Designed for use with the WD-40 spray applicator.* **\$36<sup>95</sup>** GREAT VALUE!

- When you need to use a lot of WD-40, sometimes a can just isn't enough. That's why WD-40 is available in a bulk liquid varieties.
- Soak parts to clean parts without disassembly.
  - Lubricates and protects industrial equipment.
  - Cleans and removes residue from moulds.
  - Penetrates stuck rigging hardware.

20 LITRE, P/N: 45020

4 LITRE, P/N: 45040





# GIFT CARDS

AVAILABLE IN SELECTED STORES

## CHEMICALS

### GalMax™ GAME CHANGING GAL PAINTS



#### COLD GAL 90

CT-CG-400  
400G AEROSOL | \$11.95

- ✓ 90% zinc in dry film
- ✓ 99% zinc purity

#### SG SILVER GAL

CT-SG-400  
400G AEROSOL | \$12.95

- ✓ Protect - Match - Seal
- ✓ 99% zinc purity

PRICED FROM  
**\$11.95**



#### GREY ETCH PRIMER

CT-EPGY-400 | 400G AEROSOL | \$14.95

- ✓ Ferrous & non-ferrous metal surfaces

#### NPR COLOURED GAL PAINT

CT-MBKS-400 | 400G AEROSOL | MATT BLACK  
CT-BKSG-400 | 400G AEROSOL | GLOSS BLACK

- ✓ No primer required
- ✓ Smooth & durable finish

» Many other available colours, including John Deere® Green and Caterpillar® Yellow. Contact Chemtools for more details.

BOTH COLOURS  
**\$13.95**

### A NEW FORCE IN CHEMICAL MANUFACTURING

WWW.CHEMTOOLS.COM.AU

#### INDUSTRIAL CLEANER & DEGREASER

CT-ICL-20L | 20L DRUM



- ✓ Great product for concrete & workshop floors
- ✓ Fast acting & safe
- ✓ Ready-to-use

CLEANING UP AT  
**\$49.95**

CONCENTRATED FORMULA:  
CT-ICLC-20L | 20L DRUM | \$99.00

#### TRUCK WASH HEAVY DUTY

CT-TWHD-20L | 20L DRUM

- ✓ Streak-free
- ✓ Inhibits rust
- ✓ Highly concentrated

DILUTE UP TO 1:250  
**\$79.00**

EXTREME PERFORMANCE

FORMULATED FOR HEAVY VEHICLES



#### CONCRETE & MORTAR REMOVER

CT-LC101-20L | 20L DRUM

- ✓ Turns concrete, grout & mortar into a soft paste
- ✓ Safe for tools & most surfaces



BIODEGRADABLE  
**\$279**

#### NEW! GRIT-MATE HAND CLEANER

- ✓ Industrial strength
- ✓ Ultra-fine particles
- ✓ Kills a broad range of germs & bacteria

PRICED FROM  
**\$39.95**



CT-MHC-5L | 5L PUMP BOTTLE | \$39.95  
CT-MHC-20L | 20L DRUM | \$129.00

## Dy-Mark

#### DY-MARK® 2-WHEEL SPOT MARKING HANDLE

**\$890\***  
EACH  
CODE: 40090110



**\$695\***  
3500 - EACH

#### DY-MARK® LONG ARM HANDLE

**\$790\***  
EACH  
CODE: 40080105

## FOR BRIGHT VISIBLE MARKS ON YOUR JOBSITE

Available in an extensive range of colours.

Unique spray pattern specifically designed for spot marking as well as "writing" applications.

Suitable for use with the Dy-Mark® Long Arm Handle and 2-Wheel Spot Marking Handle.

## FOR ANY METAL PROTECTION JOB, GUARD AGAINST CORROSION WITH DY-MARK® ZINC GUARD®

\*All prices are GST Inclusive



**\$235 00\***  
4L - EACH  
CODE: 230731400

**\$6900\***  
1L - EACH  
CODE: 230731100

**\$4995\***  
500ML - EACH  
CODE: 230731050

**\$1395\***  
EACH  
CODE: 230732006  
CODE: 230732007  
CODE: 230732008  
CODE: 230732009



# TAX TIME SAVINGS

## LIFTING/RIGGING

### BEAVER LIFTING & RIGGING

#### BEAVER 1T ROUND LIFTING SLING - 1000kg x 2m

Code: MRS1000X2

- High strength, lightweight & easy to use. Manufactured to AS4497.1.1



**\$895**  
SPECIAL PRICE

Also Available

MRS1000X1	1000kg x 1m	\$4.95
MRS1000X3	1000kg x 3m	\$12.95
MRS1000X4	1000kg x 4m	\$16.95

#### BEAVER 2T ROUND LIFTING SLINGS - 2000kg x 1m

Code: MRS2000X1

- High strength, lightweight & easy to use. Manufactured to AS4497.1.1



**\$795**  
SPECIAL PRICE

Also Available

MRS2000X2	2000kg x 2m	\$13.95
MRS2000X3	2000kg x 3m	\$19.95
MRS2000X4	2000kg x 4m	\$26.95

#### BEAVER 3T ROUND LIFTING SLINGS - 3000kg x 1m

Code: MRS3000X1

- High strength, lightweight & easy to use. Manufactured to AS4497.1.1



**\$1095**  
SPECIAL PRICE

Also Available

MRS3000X2	3000kg x 2m	\$19.95
MRS3000X3	3000kg x 3m	\$29.95
MRS3000X4	3000kg x 4m	\$38.95

#### BEAVER 3S LEVER BLOCK - 250kg x 1.5m Aluminium Gunmetal

Code: 506025

- Heavy duty steel casing
- High quality Grade 80 chain, fitted with guides stop load jumping



**\$11900**  
GREAT VALUE

COLOUR CODED FOR SAFETY

Also Available

506050	500kg x 1.5m Al-Gunmetal	\$179.00
506080	800kg x 1.5m White	\$199.00
506160	1.6T x 1.5m - Violet	\$239.00
506320	3.2T x 1.5m - Yellow	\$429.00

#### BEAVER 1T FLAT LIFTING SLING - 1000kg x 2m

Code: FS-2-1000X2

- High strength, extremely lightweight all purpose sling. Manufactured to AS1353.1



**\$995**  
SPECIAL PRICE

Also Available

FS-2-1000X1	1000kg x 1m	\$5.50
FS-2-1000X3	1000kg x 3m	\$12.95
FS-2-1000X4	1000kg x 4m	\$16.95

#### BEAVER 2T FLAT LIFTING SLINGS - 2000kg x 1m

Code: FS-2-2000X1

- High strength, extremely lightweight all purpose sling. Manufactured to AS1353.1



**\$895**  
SPECIAL PRICE

Also Available

FS-2-2000X2	2000kg x 2m	\$15.50
FS-2-2000X3	2000kg x 3m	\$21.95
FS-2-2000X4	2000kg x 4m	\$28.95

#### BEAVER 3T FLAT LIFTING SLINGS - 3000kg X 1m

Code: FS-2-3000X1

- High strength, extremely lightweight all purpose sling. Manufactured to AS1353.1



**\$1295**  
SPECIAL PRICE

Also Available

FS-2-3000X2	3000kg x 2m	\$22.95
FS-2-3000X3	3000kg x 3m	\$31.95
FS-2-3000X4	3000kg x 4m	\$39.95

#### BEAVER 3S INDUSTRIAL CHAIN BLOCKS - 500kg x 3m White

Code: 503053

- Heavy duty casing & grade 80 chain
- Superior braking systems



**\$14900**  
GREAT VALUE

COLOUR CODED FOR SAFETY

Also Available

503103	1T x 3m - Violet	\$179.00
503203	2T x 3m - Green	\$269.00
503303	3T x 3m - Yellow	\$329.00

### BEAVER LOAD RESTRAINT

#### BEAVER HAND RATCHET & STRAP - 50mm x 9m

Code: RTD055PL

- LC: 2500kg
- With double pawl action safety locking system
- Heavy duty webbing and reinforced eyes



**\$1895**  
HOT BUY

Also Available

RTD055PL-12	50mm x 12m - LC 2500kg	\$34.95
-------------	------------------------	---------

#### BEAVER HAND RATCHET & STRAP - 25mm x 5m

Code: 349025RB

- LC: 500kg
- Includes 2 protective sleeves



**\$1295**  
SPECIAL PRICE

Also Available

349035RB	35mm x 6m - LC 1500kg	19.95
----------	-----------------------	-------

#### BEAVER GRADE 70 TRANSPORT CHAIN KITS - 9m

Code: 145128

- LC: 3800kg
- High tensile strength chain
- Fitted with grab hooks



**\$7900**  
GREAT VALUE!

#### BEAVER RATCHET LOADBINDERS WITH GRAB HOOKS - 8mm

Code: 344008

- LC: 9000kgs
- With eye grab hooks



**\$4695**  
GREAT VALUE!

Also Available

344010	10mm LC: 9T	\$62.95
344013	13mm LC: 9T	\$79.00

### PREMIUM FOOTWEAR

**MACK**

#### MACK CARPENTER ZIP SAFETY BOOTS - HONEY

Code: MKCARPENTHHF

- Sizes: 6-14, Half Sizes 6.5-10.5
- Steel toe cap
- Heat (150°C), water & slip resistant



**\$10900**  
SPECIAL PRICE

#### MACK TRADESMAN SAFETY BOOTS - BLACK

Code: MKOTRADESBBF

- Sizes: 4-16, Half Sizes 5.5-11.5
- Steel toe cap
- Heat (150°C), water & slip resistant



**\$8900**  
SPECIAL PRICE

### HEIGHT SAFETY

**B-Safe**

#### B-SAFE FALL ARREST HARNESS

Code: BH01120

- Lightweight & comfortable
- With front & rear attachment points



**\$11900**  
SPECIAL PRICE

#### B-SAFE FALL ARREST HARNESS WITH LANYARD & WAIST STRAP

Code: BH01151

- Lightweight & comfortable
- 2m shock absorbing lanyard, front & rear attachments



**\$19900**  
SPECIAL PRICE





# macnaught **MAC VALUABLE DEALS**

**\$549<sup>00</sup>**  
GREAT VALUE!



## BOP20 BATTERY OPERATED PUMP

### Battery Operated Pump Starter Kit 20L

BP20S-OLA

- Includes Powerhead (BP20-PH), 1X Battery (BPB-20AH) & Charger (BPC-A)
- On demand flow control
- Lubricant range - SAE 0W40 to 75W90
- Adaptors to suit most 20L drums
- Drum size - Nominal 15-25L
- Delivery rate - Up to 3.5L/min
- Battery - 18V 2.0Ah Li-Ion 1hr fast charge



**\$169<sup>00</sup>**  
GREAT VALUE!

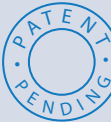

**2 YEARS**  
MACNAUGHT WARRANTY\*

### Battery Operated Pump Stem Kit 20L ATF

BP20X-ALA

- ATF pump stem, nozzle & 1.5m hose included
- Delivery rate - Up to 4.5L/min

**\$599<sup>00</sup>**  
GREAT VALUE!

**10 YEARS**  
MACNAUGHT WARRANTY\*



## RETRACTA<sup>®</sup> by macnaught

### Retracta R3 Oxy/Acet reel

OA215B-04

- Hose Size - 5mm twin hose x 15m
- Hose Type - Oxy/Acet
- Inlet/Outlet - Gas Thread/ Gas Thread
- Pressure Rating - 175 psi
- Hose Material - Reinforced Rubber (AS1335)



**\$429<sup>00</sup>**  
GREAT VALUE!

**10 YEARS**  
MACNAUGHT WARRANTY\*



### Retracta R3 Hot Wash reel

HW420R-01

- Hose Size - 1/2"x 20m
- Hose Type - Hot Water
- Inlet/Outlet - 1/2"/1/2" BSP
- Pressure Rating - 150 psi
- Hose Material - HT chem resistant PVC



**\$1,299<sup>00</sup>**  
GREAT VALUE!

**10 YEARS**  
MACNAUGHT WARRANTY\*

### POWERLUBE<sup>®</sup> Greasing System

P3-01C

- Compatible with 20kg (or similar size) pails
- 50:1 air-operated grease pump
- High Output: up to 460g/min free flow
- Max pump output pressure: 7,500psi (51,700kPa)



**\$125<sup>00</sup>**  
GREAT VALUE!

### FLEXIGUN<sup>®</sup> 450G Grease Gun

K29-01

- Delivery pressure up to 10,000psi (68,900kPa)
- Flexible 230mm (9") high pressure extension hose
- Up to 0.68g per shot
- Maximum viscosity - Up to NLGI 2



**10 YEARS**  
MACNAUGHT WARRANTY\*

**\$499<sup>95</sup>**  
GREAT VALUE!

**2 YEARS**  
MACNAUGHT WARRANTY\*

### All Purpose 20L Oil Transfer Pump

MAOP20

- Suitable for oils up to SAE140 / ISO680 viscosity
- Used for engine, gear, transmission, hydraulic oils and pre-mixed engine coolants
- Delivers up to 75ml per stroke, viscosity dependant



**\$1,499<sup>00</sup>**  
GREAT VALUE!

**5 YEARS**  
MACNAUGHT WARRANTY\*

### 240V Diesel Mini Bowser 60L

AMB60L

- Suitable for Diesel use only
- Flow rate up to 60LPM
- Inlet/Outlet: 1" BSP(F)
- 30-minute duty cycle
- Built-in nozzle holder with on/off switch



**\$459<sup>00</sup>**  
GREAT VALUE!

### 12V Manual Diesel Pump Kit

AFP12M

- Manual nozzle
- Flow rate up to 40LPM
- Suitable for diesel use only
- 12V or 24V options available
- 30min duty cycle
- Inlet and Outlet: 3/4" BSP (F)



**\$479<sup>00</sup>**  
GREAT VALUE!

### 12V Automatic Diesel Pump Kit

AFP12A

- Automatic nozzle
- Flow rate up to 40LPM
- Suitable for diesel use only
- 12V or 24V options available
- 30min duty cycle
- Inlet and Outlet: 3/4" BSP (F)



**5 YEARS**  
MACNAUGHT WARRANTY\*

## lubemate<sup>®</sup> by macnaught

**\$399<sup>00</sup>**  
GREAT VALUE!

**12 MONTH**  
MACNAUGHT WARRANTY\*

### BI-LOBE Fuel Pump, Hose & Fuel Filter

L-BLPH-KIT

- Flow rate up to 100LPM
- Suitable for diesel, kerosene and light viscosity oils up to SAE30
- Fits 60 - 205L containers
- Bonus Macnaught HA-01 Fuel Filter



**\$189<sup>00</sup>**  
GREAT VALUE!

**12 MONTH**  
MACNAUGHT WARRANTY\*

### 6L Pneumatic & Manual Oil Extractor

L-OE6PM

- Capacity - 6 Litres
- Max Temp - 100°C
- Working Pressure - 90psi
- Air Inlet Size - 1/4" NPT
- Includes: 3 Tubes



\*Prices inclusive of GST. Stock Subject to availability. Warranty subject to Macnaught Terms & Conditions. ©Macnaught Pty Ltd, 2020.



38L 1500W WET/DRY INDUSTRIAL M CLASS VACUUM

Air Flow Sensor | Push & Clean Filter System | Heavy Duty Castors  
Anti-static system | Variable Suction Power | 800W Power take off (PTO)

AVAILABLE NOW





# INDUSTRIAL STRENGTH QUALITY EQUIPMENT

## 501A ROTARY ACTION DRUM PUMP

- Suitable for the transfer of diesel, petrols, kerosene, lube oil and machine oil
- Delivery rates of 18L/min or 0.26L per rotation
- 2" BSP bung adaptor
- Anti static fuel hose
- Length: 1,300mm
- Delivery tube: 31.8mm (1") OD
- Hose: 19.05mm (3/4") ID x 2.2m
- Includes 2.2m of farm tank hose, bung adaptor, rubber gasket, a four chamber rotor assembly, spout and spout holster



**\$179.00**  
GREAT VALUE!

## 801A STAINLESS STEEL ROTARY ACTION PUMP

- Rotary action facilitates quick and effortless fluid transfer
- 2" standard BSPT bung adaptor
- Suitable for 60L or 205L drums
- Flow rates of up to 18L/min or 0.3L per rotation
- Wetted parts of 304 stainless steel, Teflon and Ryton® rotor
- Effortless rotary action operation
- Suitable for the transfer of ammonia, ethyl acetate, methyl acetate, AdBlue® and nitric acid up to a 50% concentration



**\$599.00**  
GREAT VALUE!

## G10020N ALEMLUBE EL SERIES LEVER ACTION GREASE GUN

- Grease pressures of up to 8,000psi (552bar)
- Delivery rates of up to 0.95g per stroke
- Robust die cast head assembly
- Ideal for seasonal or intermittent use
- Heavy duty 4 jaw coupler



**\$44.95**  
GREAT VALUE!

## 424170 SAMOA 20KG GREASE KIT

- Delivery rates of up to 0.9kg/min
- 55:1 ratio air motor develops grease pressures of up to 7,950psi (548bar)
- Supplied with a 4m long hose assembly enabling quicker and easier greasing of your plant and equipment
- Will handle high density, tacky greases up to NLGI2
- Easily adjustable bung adaptor enables the kit to be used on a variety of drum sizes and types



**\$1,279.00**  
GREAT VALUE!

## 51039 AUTOMATIC DIESEL NOZZLE

- Automatically cuts off when a fuel tank is full
- Can operate with flow rates of up to 120L/min
- 1" BSPT swivel included
- Suitable for applications involving an electric diesel transfer pump

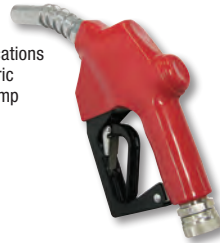

**\$309.00**  
GREAT VALUE!

## 600A LEVER ACTION GREASE GUN

- Grease pressures of up to 12,000psi (828bar)
- Delivers up to 1.6g of grease per stroke
- 450g capacity
- Suitable for all grease grades up to NLGI3
- Bulk filling capacity of 500g
- Ever-Flow System enables the use of thick/tacky greases
- 4 jaw coupler & rigid extension
- Large diameter piston with a long lever travel facilitates high volume greasing



**\$95.00**  
GREAT VALUE!

## 332080N2 ADBLUE® TRANSFER ROTARY DRUM PUMP

- Flow rates of 380ml per rotation or up to 38L/min
- 3-piece downtube suits 20L, 60L and 205L drums
- Stainless steel, polypropylene with 30% fibreglass construction
- Operating temperature from -5°C to +45°C
- 2.5m clear delivery hose complete with stainless steel spout
- Trisure and Mauer drum bung adaptors included
- Also suitable for dispensing water and antifreeze



**\$339.00**  
GREAT VALUE!

## HR40030 ALEMLUBE EL SERIES AIR HOSE REEL

- Supplied complete with 20m x 10mm ID PVC hose and 0.9m lead in hose
- Max working pressure of 300psi (20bar)
- 3/8" BSPT inlet/outlet
- Increase safety by reducing rewind speed by up to 80%
- Convenient carry handle facilitates portable use
- Can be wall or ceiling mounted



**\$189.00**  
GREAT VALUE!

Also available:  
HR40040 as above but with  
15m x 12mm ID PVC hose \$199

## SJ-300-001 2 DRUM WORKFLOOR & SPILL CONTAINER

- Flexible workfloor system ideal for liquid storage and frequent dispensing
- 100% UV resistant recyclable polyethylene construction
- Excellent chemical resistance
- Sump capacity of 120L
- Dimensions of 800mm (L) x 1,600mm (W) x 150mm (H)
- Weight of 24kg

Also available: SJ-300-006 as above but for 4 Drum \$1,199



**\$849.00**  
GREAT VALUE!



\*Applies to the vast majority of Alemlube products unless indicated otherwise

alemlube.com.au

**WIDE RANGE OF TRAILER  
PARTS INSTORE**



ALL STATES  
**TRAILER  
SPARES**



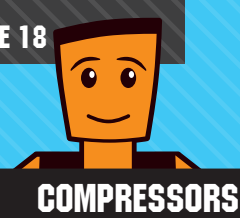

# HOT DEALS STOREWIDE!

## COMPRESSORS



**\$489<sup>00</sup>**

**PB2500TT**

### Peerless Black 2500 Twin Tank

- Free Air Delivery: 154 LPM
- 2.5HP Electric motor - 10AMP
- 18 Litre Air Receiver • Max PSI: 145
- Warranty: 1 year total unit



**\$329<sup>00</sup>**

**PB2500**

### Peerless Black 2500 Direct Drive

- Free Air Delivery: 154 LPM
- 2.5HP Electric motor - 10AMP
- 30 Litre Air Receiver • Max PSI: 145
- Warranty: 1 year total unit



**\$899<sup>00</sup>**

**PB14000**

### Peerless Black 14000 Electric

- Free Air Delivery: 220 LPM
- 2.5HP Electric motor - 10AMP
- 50 Litre Air Receiver • Max PSI: 145
- Warranty: 1 year total unit



**\$1799<sup>00</sup>**

**PB17000P**

### Peerless Black 17000 Petrol

- Free Air Delivery: 320 LPM
- GX200 Honda Motor
- 9 Litre Air Receiver • Max PSI: 145
- Warranty: 1 year pump, 3 year Honda



### PHP15 Fat Boy High Pressure

- Free Air Delivery @ 150PSI: 300LPM
- 3.5HP Single Phase motor - 15AMP
- 110L air receiver
- Perfect for truck tyre inflation!
- Warranty: 5 year pump, 1 year motor

**\$1999<sup>00</sup>**

**00105**



### 10HP Variable Speed Screw Compressor

- Free Air Delivery @ 116PSI: 1000LPM
- 10HP Variable speed motor - 415V
- 136L Twin air receiver
- Only 1050MM x 700MM x 1360MM
- Schneider electrical components
- Warranty: 1 year full industrial warranty
- UPGRADE YOUR WORKSHOP AIR COMPRESSOR
- SAVE MONEY & POWER WITH VARIABLE SPEED TECHNOLOGY
- GREATER AIR EFFICIENCY ON DEMAND WHEN REQUIRED

**\$9900<sup>00</sup>**

**HQD10VS-TT**



**G12**

### AIR COMPRESSOR

- Filter / regulator
- 348 Lt/min Displacement
- 238 Lt/min F.A.D.
- 2 Cylinder cast-iron pump
- 1.65kW / 2.2HP TECO motor
- 240V, 10Amp
- 60 litre tank



**\$1199**

**TECO MOTOR**



**C16L-HP**

### AIR COMPRESSOR

- High pressure – 160p.s.i.
- Filter / regulator
- 410 Lt/min Displacement
- 328 Lt/min F.A.D.
- 2.2kW / 3HP, 240VTECO motor
- 125 litre tank
- Forklift feet
- Ideal for truck tyres

**\$1999**

**160 P.S.I.**



**HIGH PRESSURE**



Powered By **HONDA**

**AFP38**

### AIR COMPRESSOR

- Honda 6.5HP engine
- 518 LT/min Displacement
- 400 LT/min F.A.D.
- Auto Idle control
- 60 Lt tank
- 10" Pneumatic wheels
- Removable handle

**\$2349**

**HONDA ENGINE**

**G16**

### AIR COMPRESSOR

- Filter / regulator
- 453 Lt/min Displacement
- 328 Lt/min F.A.D.
- 3 Cylinder cast-iron pump
- 2.2kW / 3.0HP TECO motor
- 240V, 15Amp
- 60 litre tank



**\$1399**

**TECO MOTOR**

**E21**

### TANK AUTO DRAIN

- 240V
- Solenoid controlled
- Adjustable timer
- Protective strainer
- 3m lead

**\$199**

**GREAT BUY**



**WATER ELIMINATOR**



# WHEN HEAVY DUTY MATTERS!

WORKSHOP



## WORKSHOP TOOLS & MACHINERY

### Holemaker

Drilling Solutions By ITM®

#### HOLEMAKER PRO 35 MAGNETIC BASE DRILL

- Quality, Compact & Robust European Made Machine
- Lightweight, only 10kg! Ideal for onsite & overhead tasks
- Capacity (diameter) 35mm • Capacity (depth) 52mm • Gravity feed coolant system with magnetically attached bottle • Comes complete in plastic carry case



**\$999.00**  
GREAT VALUE  
HMPRO35

TradeSmart BONUS DEALS!  
3PCE CUTTER SET ASSET-Z

### Multitool

INTERNATIONAL

**\$479.00**  
GREAT VALUE

PO362-200

#### 200MM BENCH GRINDER WITH MULTITOOL BELT ATTACHMENT

- Powerful 600W induction motor • Capacitor start for maximum performance • 915mm x 50mm belt • 178mm disc • 25mm wide grinding wheel • Durable cast iron body • Heavy duty tool rest
- Also available: 250mm 900w bench grinder with 1220 x 50mm attachment (PO482-250) \$899



**\$269.00**  
GREAT VALUE

PO362

#### 915 X 50MM BELT & DISC GRINDING ATTACHMENT

- Suits most bench grinders • Ideal for sharpening, sanding, polishing & more • 178mm sanding disc
- Also available: 1220 x 50mm attachment (PO482) \$499

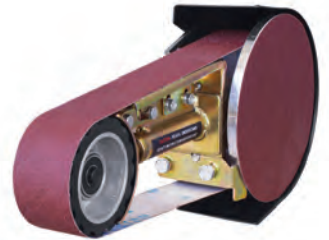

### Ehoma

Clamping Solutions By ITM®

#### GENERAL PURPOSE FORGED STEEL CLAMPS

- For general purpose clamping applications • Swivel pad

Span x Depth	Clamping Force	Part No.	Price
160x80mm	300kg	EC-G16CS	\$34.95
200x100mm	450kg	EC-G20CS	\$44.95
250x120mm	550kg	EC-G25CS	\$55.00
300x140mm	670kg	EC-G30CS	\$69.00
400x175mm	1000kg	EC-G40CS	\$89.00
600x175mm	1000kg	EC-G60CS	\$108.00
800x175mm	1000kg	EC-G80CS	\$125.00



**\$159.00**  
GREAT VALUE

TM101-125

#### MULTI-PURPOSE BENCH VICE

- Jaw width : 135mm • Jaw opening : 135mm • Pipe holding capacity : 25mm - 65mm • 18.5kg • Hardened & tempered jaws • 360° Rotation with safety locking nuts • 360° Swivel base • Hardened anvil

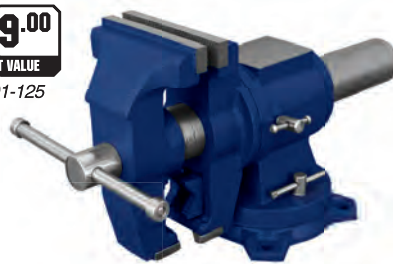

Length	Part No.	Price
750mm	TM601-075	\$129
900mm	TM601-090	\$179
1050mm	TM601-105	\$229

#### EXTRA HEAVY DUTY BOLT CUTTERS

- Optimal performance for cutting high tensile material
- Two stage heat treated, precision machined jaws for extended cutting and resilience • Adjustable arms
- Solid forged steel handles for durability • Built in stops for added safety

#### 220MM X 220MM CAPACITY SWIVEL HEAD BANDSAW

**\$2899.00**  
GREAT VALUE

WP270SH-1

- 1 Way swivel head 0° to 60°
- Taiwanese made machine
- Hydraulic down feed • 1.5HP, 240V • 1 Speed 72mpm
- Round cut capacity, 90° : 227mm, 45° : 150mm, 60° : 90mm



### Drill Doctor

The Drill Bit Sharpener

**\$249.00**  
GREAT VALUE

DDXP

#### DRILL DOCTOR XP DRILL BIT SHARPENER

- 2.5mm to 13mm drill bit capacity • Creates & sharpens split point bits • 118° sharpening angle
- Adjustable relief angle • 240V motor • 3 year warranty



### ITM AIR

#### HIGH-FLEX AIR HOSES

- Hybrid polymer High-Flex hose • Anti-kink technology, the hose will not kink when under pressure • Superior all weather flexibility -5°C to 65°C • 300PSI maximum working pressure • Hi-visibility for safety

Description	Fitting	Part No.	Price
15M 3/8" I.D.	1/4" BSP	TM300-315	\$49
30M 3/8" I.D.	1/4" BSP	TM300-330	\$79



TradeSmart BONUS DEALS!  
1/2" IMPACT SOCKET SET 11PCE TM371-001

**\$369.00**  
GREAT VALUE

M7-NC4255QH

#### 1/2" AIR IMPACT WRENCH

- Lightweight - Only 1.7KG!
- Powerful - 1650Nm (1200ft-lb) Max Torque! • Value For Money - High quality & specs • 25mm Bolt capacity • 4.8 CFM Air consumption • Magnesium composite body



**\$215.00**  
GREAT VALUE

M7-SN1288

#### AIR NEEDLE SCALER

- Blows per minute : 5500 BPM • Net weight : 1.3kg
- Needle size : 3 x 123mm (12 per set) • Overall length : 290mm



#### HIGH-FLEX AIR HOSES - BULK

- No fittings or collar

Description	Part No.	Price
100M 3/8" I.D.	TM300-3100	\$300
100M 1/2" I.D.	TM300-4100	\$400
100M 3/4" I.D.	TM300-5100	\$650



FREIGHT CHARGES MAY APPLY





HEATING/VENTILATION

WALL & PEDESTAL RADIANT HEATER



PRICED FROM...  
**\$89<sup>00</sup>**

- 240V 3 Pin 10A Plug
- 650/1350/2000W
- 3 heat settings
- Pull cord switch to turn on
- Will heat up to 12m<sup>2</sup>

PART NO.	DESC.	PRICE INC GST
IGH2W	WALL MOUNT	\$89.00
IGH2P	PEDESTAL	\$119.00

PORTABLE ELECTRIC RADIANT HEATER

**\$169<sup>00</sup>**  
GREAT VALUE!



- 2400W 240v 3 Pin 10A Plug
- Pedestal or wall mounted
- Radiant Quartz Lamp
- Fully adjustable thermostat
- Safety cut off switch

PERH2400

INDUSTRIAL DIESEL RADIANT HEATER 40KW

- 40kW 240v 3 Pin 10A Plug
- Adjustable temperature
- Diesel or Kerosene
- 38L tank capacity
- Ceramic fibre combustion chamber

HDR40

**\$1199<sup>00</sup>**  
GREAT VALUE!



LOUVRED WALL EXHAUST FANS

PRICED FROM...  
**\$139<sup>00</sup>**



- 240V Hardwired
- Perfect for workshops & garages
- Gravity louvres to stop rain & reverse airflow

PART NO.	DESC.	AIRFLOW	PRICE INC GST
IWL300	300MM	300L/S	\$139.00
IWL350	350MM	630L/S	\$159.00
IWL400	400MM	800L/S	\$199.00

INDUSTRIAL ROOF EXHAUST FAN

- 415V Hardwired
- Steel base & body
- Weather tight hood
- Airflow 1472L/s (400mm)
- 3600L/s (600mm)
- 7778L/s (800mm)

PART NO.	DESC.	PRICE INC GST
IHR4-550-4-3	400MM	\$1,099.00
IHR6-11-6-3	600MM	\$1,599.00
IHR8-22-6-3	800MM	\$2,399.00



PRICED FROM...  
**\$1099**

ELECTRIC SPACE HEATER

HES2.4

GREAT VALUE!

**\$129<sup>00</sup>**  
HOT BUY!



- 2400W 240v 3 Pin 10A Plug
- Suitable for heating or drying
- Heats up to 12m<sup>2</sup>
- Adjustable heat & fan settings
- Lightweight & portable

INDUSTRIAL LPG FAN HEATER

IGH2-20

**\$299<sup>00</sup>**  
GREAT VALUE!



- 20kW 240v 3 Pin 10A Plug
- Airflow 139L/s
- Portable & Lightweight
- Low Gas Consumption

PORTABLE VENTILATOR WITH 5M DUCTING

**\$249<sup>00</sup>**  
HOT BUY!



- 240V 3 Pin 10A
- Airflow: 1083L/s
- 520W Motor
- Comes with 5m of ducting

MPVIFD300

NEW PRODUCTS

INDIRECT FIRED DIESEL FAN HEATERS



PRICED FROM...  
**\$799**

PART NO.	MOTOR	PRICE INC GST
IDH2-20IN	20KW	\$799.00
IDH2-50IN	50KW	\$1,999.00

- 240V 3 Pin 10A Plug
- Diesel or Kerosene
- Airflow 166L/s (20kW) 555L/s (50kW)
- Capable of heating up to 200m<sup>2</sup> (20kW) & 500m<sup>2</sup> (50kW)



INDUSTRIAL PORTABLE FUME COLLECTORS

PRICED FROM...  
**\$3495**



NEW!

**DID YOU KNOW** Welding fumes – fine metal particles produced through welding that can be breathed in – have been classified as carcinogenic. This means employers in mining and other industries where welding takes place must make sure workers are protected, for example by installing welding fume extractors.

- HEPA Filters for Air Purification
- Fume arm 360° rotation
- Portable with castors & brake function
- Purification of welding & grinding fumes & dust

PART NO.	MOTOR	VOLTAGE	PLUG	PRICE INC GST
IPFC-075	0.75KW	220~240V/50HZ	3 PIN 10A	\$3,495.00
IPFC-15	1.5KW	415V/50HZ	4 PIN 10A	\$6,995.00
IPFC-30	3.0KW	415V/50HZ	4 PIN 20A	\$8,495.00

INDUSTRIAL WALL LOUVRED FAN

**\$999<sup>00</sup>**  
GREAT VALUE!



- 240V Hardwired
- Airflow 5000L/s
- Internal gravity louvres
- Exhaust or supplies air
- Featuring a galvanised steel body with rain cover

IWL6-11-6

INDUSTRIAL GALVANISED LOUVRED FAN

PRICED FROM...  
**\$1,299**

- 415V Hardwired
- Extracts large volumes of air
- Airflow: 9000L/s (950mm)
- 12500L/s (1250mm)

PART NO.	DESC.	PRICE INC GST
IGLF950	950MM	\$1,299.00
IGLF1250	1250MM	\$1,699.00



**FANMASTER**  
COOLING HEATING VENTILATION EXTRACTION

THE RISK IS REAL ... PROTECTING YOURSELF IS EASY!

A number of Australian companies are now changing their stance on PPE for welders after the reclassification of welding fume by the International Agency for research on cancer. Many companies are strengthening their controls by enforcing the use of welding Powered Air Purifying Respirators (PAPR's) to reduce welding fume exposure to "As Low As Reasonably Practicable."





# HOT DEALS STORE WIDE

HEATING/WELDING

## LAVOR

SIMPLY STRONGER

TradeSmart  
MATES RATES!



PRESSURE  
CLEANER

### Vertigo20

- 2030 PSI (140 Bar)
- 6.7 LPM, 400 litres/hour
- Spray lance, vario, plastic Turbo lance
- 8 metre nylon reinforced HP hose
- On board detergent tank
- Automatic Stop System
- Induction motor

P/N: Vertigo20

**\$399**

SUPER SPECIAL!

### Ninja130 PLUS

- 1885PSI
- 7LPM flowrate Max
- LAVOR metal alloy pump
- 6 metre nylon reinforced HP hose
- Fixed spray and turbo spray nozzles
- 1800W universal brush motor (1Ph - 10Amp)

P/N: Ninja130 PLUS

**\$259**

RED HOT DEAL!



### FF175 Fan Forced Diesel Heater

- FF175
- Fan forced diesel heater
- 175,000 BTU (51.3KW) of heat
- Heating area 400sqm
- Fuel tank 49 litres
- Operating hours 10hrs
- Thermostat controlled

P/N: FF175

**\$849**

BEST HEATER DEAL!



EFFICIENT  
HEATING

### PT70SS PLUS Radiant Diesel Heater

- Radiant diesel heater (21KW, 70000 BTU)
- Heating area capacity 200m2 (approx.)
- Non continuous spark for extremely quiet operation
- Fuel tank capacity 15lt.
- Diesel consumption 1.9 lt./h (Up to 8 hrs capac.)
- Thermostat control for maximum efficiency

P/N: PT70SS PLUS

**\$799**

HOT SAVINGS!



**LINCOLN**  
ELECTRIC

Innovative Technology. Comprehensive Welding and Cutting Solutions.

BONUS S6  
MIG WIRE

**\$1,599<sup>00</sup>**  
BONUS WIRE



#### Powercraft® 250C 'Ready to weld'

The 250C is easy to use, with the weld procedure guide attached in the machine set the wire feed speed and voltage for the wire size and plate thickness you are using. Includes many features normally found on larger industrial welders such as; digital volt/amp meter, gas purge, cold wire feed, external polarity selection, 4T/2T trigger latching, adjustable inductance/arc force and VRD. The 250C are compact and lightweight and are supplied with all the accessories so it is ready to weld out of the box. **Bonus inclusions:** 15kg UltraMag S6 MIG wire 0.9mm and 4.5kg Steelcore gasless wire 71T1 0.9mm. PART NUMBER: K69033-1A

BONUS STICK  
WELDER

**\$1,499<sup>00</sup>**  
BONUS PACK



#### PowerMIG® 180C 'Ready-to-Weld'

Compact and reliable with superior arc performance with 30-180 Amp output with wide voltage 'sweet spot'. Extremely low spatter and stepless control voltage for precise adjustments. Light industrial, workshop, site maintenance work, vehicle repairs and agricultural applications.

**Bonus Powercraft® 131 'Ready-to-Weld' Stick Welder** Ideal for light to medium duty welding application. It is an ideal choice for maintenance, small repairs and general fabrication. PART NUMBER: K2668-1BP

Shadow™ Split  
Leather-Sleeved Jacket  
Durable split cowhide sleeves, combined with cool flame retardant material on the chest, offer extra protection for MIG or stick welding. A flip up collar is secured by hook and loop and a lined flap on the back snaps closed for extra protection. Two horizontal hip pockets with hook and loop secured flaps stow your personal items.

**\$109<sup>00</sup>**  
EACH  
SAFETY FIRST



PART NUMBERS: K2986-M, K2986-L, K2986-XL, K2986-XXXL



**\$14<sup>95</sup>**  
PROTECTION

**Premium Leather MIG / Stick Welding Gloves**  
Durable side split cowhide deliver superior comfort and performance. One size fits all. PART NUMBER: LA120-2

www.lincolnelectric.com.au

FREIGHT CHARGES MAY APPLY





# SHOP SMART - BUY SMART!

## WELDING

### MST 188X

MIG • STICK • TIG Inverter

- Plug size **10 Amp**
- Duty cycle **10% @ 180Amps**
- Generator **9kVA**
- Material:
  - Mild Steel • Brass
  - Stainless • Copper
  - Aluminium (see note)
- Plate Thickness **Maximum 8mm**



**BUNDLE CONTAINS**

- MST 188X Inverter Welder
- Wide View Welding Helmet
- 16" Black & Gold Welding Gloves
- Gasless 11 MIG wire x 0.8mm (4.5kg)

P/N: 699188BONUS

**\$699.00 EA**  
PACKAGE DEAL!

### MST 248X

Inverter Welder



**KEY FEATURES**

- 220 Amp output
- MIG /Stick /TIG welder
- Fitted 15 Amp plug
- DC TIG lift arc start
- Gas /gasless operation
- 2T / 4T trigger latching
- Stepless amperage control
- Generator safe
- Suits D200/D300 spools
- Spool gun ready

P/N: 699248BONUS

**\$1099.00 EA**  
BONUS ITEM!

### AC-DC 200X

TIG Inverter



**KEY FEATURES**

- 200 Amp output
- High frequency arc start
- Fitted 15 Amp plug
- Digital LED display
- Adjustable pulse
- Pre and post gas adjustment
- AC balance adjustment
- 2T / 4T trigger latching
- Lightweight and portable
- IGBT inverter technology

P/N: 692200FOOT

**\$1299.00 EA**  
BONUS ITEM!

### WIDE VIEW ELECTRONIC WELDING HELMETS

- Wide viewing area 100mm x 67mm
- Shade adjustable from shades 9 - 13
- Grinding mode
- Switching speed: 1/10000s
- Dual Sensor

**APPLICATIONS**

- MIG, arc and TIG welding
- Carbon arc gouging

**\$95.00 EA**  
GREAT VALUE!

**Street**  
P/N: 700198

**Urban**  
P/N: 700197

**GRAPHITE**  
P/N: 700200



### GASLESS 11 SELF SHIELDING MIG WIRE

**FEATURES**

- A5.20 E71T-11
- Self Shielded Flux Core wire
- Suitable for Multiple pass applications
- Smooth Arc action DC-
- No Shielding gas required
- All welding positions

**APPLICATIONS**

- Excellent on Galvanised steel
- General welding and repairs out doors
- Farm repairs and maintenance on heavier structures

CODE	DESCRIPTION	PRICE
200353	Bossweld Gasless 11 MIG x 0.8mm (4.5 Kg Spl)	\$67.95 / spl
200355	Bossweld Gasless 11 MIG x 0.9mm (4.5 Kg Spl)	\$64.95 / spl

**BEST IN CLASS**  
LOW FUME  
LOW SPLATTER

# BOSSWELD

WELD LIKE A BOSS

BOSSWELD.COM.AU



TAG US: #weldlikeaboss



www.steelvisiontools.com.au



### ARC-TIG 180Amp INVERTER WELDER



#### TECHNICAL DATA

Input Power 240 Volts  
 Ieff Amps 15 Amp  
 Rated Output Voltage 20.4V - 28V  
 Output Current Range MMA/TIG 10 - 180Amps  
 No Load Voltage 63  
 Duty Cycle 40°C  
 Protection Class IP21S  
 Insulation Class F  
 Specifications IEC-60974-1:2008  
 Dimensions (mm) 365x235x275  
 Weight (Kgs) 6.2

**\$299.00**  
GREAT VALUE!

PN: SVAT180

ALSO AVAILABLE AT140 - 140Amp

**\$219.00**  
GREAT DEAL!

PN: SVAT140

### PLASMA CUT 45Amp INVERTER PLASMA CUTTER



#### TECHNICAL DATA

Input Power 240 Volts  
 Ieff Amps 15 Amp  
 Rated Output Voltage 15V - 98V  
 Output Current Range 15 - 45Amps  
 Duty Cycle 40°C 15%@45Amps  
 Protection Class IP21S  
 Insulation Class F  
 Cutting Thickness Clean Cut 15mm  
 Specifications IEC-60974-1:2008  
 Dimensions (mm) 535 x345 410  
 Weight (kgs) 12.8

**\$1299**  
GREAT VALUE!

PN: SVTP40C

ALSO AVAILABLE PLASMA CUT 40 WITH BUILT IN COMPRESSOR

### MIG - MMA 165Amp INVERTER WELDER

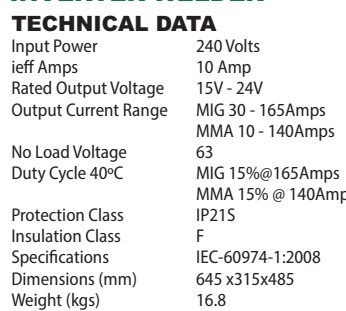

#### TECHNICAL DATA

Input Power 240 Volts  
 Ieff Amps 10 Amp  
 Rated Output Voltage 15V - 24V  
 Output Current Range MIG 30 - 165Amps  
 MMA 10 - 140Amps  
 No Load Voltage 63  
 Duty Cycle 40°C  
 Protection Class IP21S  
 Insulation Class F  
 Specifications IEC-60974-1:2008  
 Dimensions (mm) 645 x315x485  
 Weight (kgs) 16.8

ALSO AVAILABLE MS200 - 200Amp MIG-STICK INVERTER

**\$599.00**  
GREAT DEAL!

**\$749.00**  
GREAT VALUE!

PN: SVMS200

### MAX Pro 800

#### AUTOMATIC WELDING HELMET

View Colour: True Colour  
 Filter Dimension (mm): 133x114x10  
 View Area (mm): 100 x 82  
 Light to Dark Speed: 0.2ms  
 Variable Shade: 5-9 / 9-13  
 Grind Mode: Yes  
 IR / IV Protection: DIN15  
 Sensors: 4  
 Operating Temperature: -5°C to 55°C  
 Optical Classification: 1/1/1/2  
 Shade Control: Internal  
 Warranty: 2 Years  
 Standards: ANSI Z87.1/DIN/CE/CSA



**\$189.00**  
GREAT VALUE!

PN: SVMX800

ALSO AVAILABLE Pro 400

**\$89.00**  
HOT BUY!

PN: SVP400





# Weldclass WeldForce Inverter Welder Range



**WeldForce WF-180MST MIG/Stick/TIG Inverter Welder**  
WF-06128

*Includes:* MIG Torch 3m H/Duty BZL 25 / Earth Lead 3m / Stick Lead 3m / Gas Regulator / Drive Rollers for 0.8/0.9 Steel, 0.8/0.9 Gasless

**Features:**

- Takes 1kg or 5kg spools
- Digital Readouts
- 9kg - Compact, Robust & Lightweight
- Generator Compatible
- & more!

*Super compact!*

**\$699** Incl. GST



**WeldForce WF-200MST MIG/Stick/TIG Inverter Welder**  
WF-06129

*Includes:* MIG Torch 4m H/Duty BZL 25 / Earth Lead 4m H/Duty / Stick Lead 4m H/Duty / Gas Regulator / Drive Rollers for 0.8/0.9 Steel, 0.8/0.9 Gasless

**Features:**

- Takes 5kg or 15kg spools
- Digital Readouts
- 13kg - Compact, Robust & Lightweight
- Generator Compatible
- Spool Gun Ready
- & more!

*Super compact!*

**\$959** Incl. GST



**WeldForce WF-205MST MIG/Stick/TIG Inverter Welder**  
WF-06166

*Includes:* MIG Torch 4m H/Duty BZL 25 / Earth Lead 4m / Stick Lead 4m / Gas Regulator / Drive Rollers for 0.8/0.9 Steel, 0.8/0.9 Gasless, 1.0/1.2 Aluminium

**Features:**

- Power Factor Correction for High Duty Cycle + Ideal for Generator Use
- Synergic or Manual Controls
- 20+ Pre-set Programs for different materials
- Job Save store custom settings for up to 20 jobs
- & more!

**\$1,499** Incl. GST



**WeldForce WF-255MST MIG/Stick/TIG Inverter Welder**  
WF-06167

*Includes:* MIG Torch 4m H/Duty BZL 25 / Earth Lead 4m H/Duty / Stick Lead 4m H/Duty / Gas Regulator / Drive Rollers for 0.6/0.8 Steel, 0.9/1.2 Steel, 0.8/0.9 Gasless, 1.0/1.2 Aluminium

**Features:**

- Power Factor Correction for High Duty Cycle + Ideal for Generator Use
- Synergic or Manual Controls
- 20+ Pre-set Programs for different materials
- Job Save store custom settings for up to 20 jobs
- Geared 4-Roll Wire Drive System

**\$1,999** Incl. GST



**WeldForce WF-180ST Stick/TIG (Lift-Arc) Inverter Welder**  
WF-06171

*Includes:* Earth Lead 4m / Stick Lead 4m / Long 3m Power Lead / Carry Bag / Shoulder Strap / Cable Strap

**Features:**

- 4.5kg - Compact, Robust & Lightweight
- Digital Controls
- Adjustable Hot Start & Arc Force
- Optional VRD ON/OFF
- Generator Friendly
- & more!

*Digital controls!*

**\$359** Incl. GST



**CutForce CF-45P Plasma Cutter**  
WF-06176

*Includes:* Plasma Torch 6m / Air Regulator with filter & Nitro air fitting / Earth Lead 4m / Long 3m Power Lead / Carry Bag / Shoulder Strap / Cable Strap

**Features:**

- Powerful Clean Cutting
- Power Factor Correction
- 8kg - Compact, Robust & Lightweight
- High Quality Plasma Torch 6m
- Generator Friendly

*Clean cut up to 20mm steel!*

**\$1,359** Incl. GST

**Promax 350 Electronic Welding Helmet**



'Blue'

*Upgrade to a larger view!*

**\$13900** Incl. GST

WC-05313



'Fire Metal'

*4 sensors & ultra-clear vision!*

**\$14900** Incl. GST

WC-05314

**Promax 500 Electronic Welding Helmet**



'Black Stealth'

*85cm<sup>2</sup> of massive view area!*

**\$21900** Incl. GST

WC-05317



WELDWOLF

*85cm<sup>2</sup> of massive view area!*

**\$22900** Incl. GST

WC-05318



**Platinum GL-11 Gasless Wire**  
0.9mm 4.5kg  
2-098FM

Have you tried Australia's No. 1 Gasless wire? Here's what our customers say;

*"Personally I have tried many different brands and types of gasless wire but the Weldclass Gasless Platinum GL-11 has done it for me... a smooth flowing and low spatter wire."*  
- Matt, NSW

**Features:**

- Ultra-Smooth arc with minimal spatter
- Suitable for All-positional, single and multi-pass welds
- Vacuum Foil-Sealed spool, for exceptional storage life

*Australia's No. 1 gasless wire!*

**\$8900** Incl. GST





# 18 VOLT CORDLESS LiHD KITS

SSW 400 WB 125 BL M HD 5.5  
AU68200350

- Brushless 1/2" Impact Wrench 130-400 Nm
- Brushless Ø 125 mm Angle Grinder with Brake & Quick Locking Nut
- 2 x 5.5 Ah LiHD Battery Packs,
- ASC 55 Air-cooled Charger
- 2 x MetaLoc II Case



**\*Bonus via Redemption**



BL3SB2HD4.0CP  
AU68307040

- Brushless 3 Speed Hammer Drill 120 Nm
- Brushless Compact Angle Grinder
- Brushless Blind Rivet Gun
- 2 x 4.0 Ah LiHD Battery Packs
- ASC 55 Air-cooled Charger
- Small Tool Bag



**\*Bonus via Redemption**



BL6LB3HD5.5AW  
AU68600050

- Brushless Hammer Drill/Screwdriver 120 Nm
- Brushless Rotary Hammer Drill 3 Mode
- Brushless 1/4" Impact Driver Maximum Torque 200 Nm
- Brushless Ø 125 mm Angle Grinder with Brake & Quick Locking Nut
- Brushless Compact Sabre Saw
- 18 V Blower

- 3 x 5.5 Ah LiHD Battery Packs
- ASC 55 Air-cooled Charger
- Large Tool Bag



**\*Bonus via Redemption**



## 230mm ANGLE GRINDER



W 24-230 MVT - 2,400 Watt, 230mm  
606467190

- Marathon Motor
- MVT Anti Vibration Side Handle
- Rotatable Rear Handle
- Deadman Switch



TWIN PACK  
+ W850-125 125mm  
603608190

**\$349**  
MARATHON MOTOR

## 125mm ANGLE GRINDER

W 1100-125 CGD  
AU60361400

- Includes
- Grinder
- Case



**\$149**  
BRUSHLESS

**FREE**  
Cutting Guard Clip (630352000)  
Tin of 10 Cutting Discs (616359000)

## 5.5Ah LiHD Twin Pack

5.5 LiHD Twin Pack  
AU32102550

- 2 x 5.5 Ah LiHD Battery Pack



**\$249**  
LiHD BATTERIES



\*Bonus Via Redemption. For more details visit [www.metabo.com/redemptions](http://www.metabo.com/redemptions)

**metabo**  
PROFESSIONAL POWER TOOL SOLUTIONS



### DUC405Z

18Vx2 Brushless Chainsaw 400mm (16")

- Captive bar nuts
- Variable speed trigger
- Chain Speed of 1,200m/min

**\$509**

**GREAT VALUE!**



### DHS901Z

18Vx2 Brushless AWS\* 235mm (9-1/4")

Circular Saw

- Max cut capacity of 85mm with -1-60 bevel
- Automatic Torque Drive
- 4,200rpm no load speed motor

**\$499**

**GREAT VALUE!**



### DMP180Z

18V Inflator

- Auto-stop function stops at desired pressure
- High visibility digital display screen
- Max. air discharge pressure 121psi

**\$129**

**GREAT VALUE!**



### DGA519Z

18V Brushless 125mm X-Lock Angle Grinder

- X-lock allows installation of accessories in a single action
- Anti-kickback protection
- Automatic Torque Drive for optimal performance

**\$379**

**GREAT VALUE!**



### DLX2221S

18V Brushless 2 Piece Combo Kit

- Kit includes: DHP483Z & DTD155Z, 2 x BL1830B, DC18SD & carry case

**\$399**

**GREAT VALUE!**



### GA5030

125mm (5") Angle Grinder

- Slide switch with lock on function
- High durability dust protected design
- 720W\* heat resistant motor
- \*Continuous rating input

**\$85**

**GREAT VALUE!**

E&OE / W201-20

**TRADESMART MEMBERS:** ACT: • Fyshwick NSW: • Albury • Bega • Beresfield • Broken Hill • Chipping Norton • Coff's Harbour • Coonamble • Corowa • Cowra • Deniliquin • Erina • Forbes • Goulburn • Hay • Lismore • Lithgow • Moorebank • Muswellbrook • Narrabri • Penrith • Tamworth • Tomago • Tumut • West Wyalong • Wetherill Park • Young QLD: • Bohle • Bundaberg • Charters Towers • Clermont • Coomera • Caloundra • Capella • Charleville • Chinchilla • Gladstone • Longreach • Mareeba • Moranbah • Mount Isa • Proserpine • Rockhampton • Richmond • Roma • Springsure • Stanthorpe • Toowoomba • Tully SA: • Berri • Edwardstown • Kilburn • Mt Barker • Naracoorte • Newton • Penola TAS: • Invermay • Moonah • Ulverstone VIC: • Campbellfield • Cobram • Dandenong • Geelong North • Horsham • Laverton Nth • Lilydale • Mildura • Sale • Shepparton • Tullamarine WA: • Albany • Bibra Lake • Busseton • Rockingham • Narrogin • Kalgoorlie • Osborne Park • Moora • Welshpool • Wongan Hills

• ALL PRICES INCLUDE GST • Some products are subject to plus freight costs where applicable • Some advertised products may not be available at all stores & maybe subject to availability. • Prices are valid while stocks last and we reserve the right to correct any errors or omissions without prior notice • Images shown throughout this catalogue are for illustrative purposes only - some items may vary.

**FOLLOW US ON FACEBOOK** [FACEBOOK.COM/TRADESMARTINDUSTRIAL](http://FACEBOOK.COM/TRADESMARTINDUSTRIAL)

PRINTED BY: **PROMINENTGROUP**  
BEST PRINTERS IN THE COUNTRY

**PH. 1300 655 363**

